

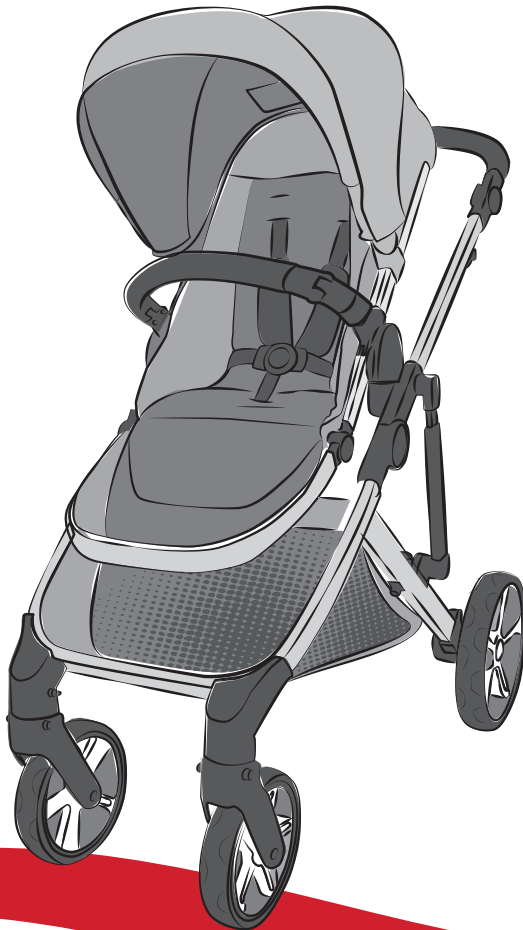

# B-READY® STROLLER

INSTRUCTION MANUAL



Note: Second Seat, Bassinet & Unity Click & Go Infant Carrier are all sold separately

**IMPORTANT: KEEP THIS BOOKLET IN A SAFE PLACE FOR FUTURE REFERENCE.**

Serial No. HB8310

# CONTENTS

---

## STROLLER SECTION

Stroller Important Notes & Warnings.....	07
Stroller Parts List.....	08
Stroller Features.....	10
Stroller Configurations.....	11

## STROLLER ASSEMBLY

Opening the stroller frame.....	13
Installing the front wheels.....	14
Removing the front wheels.....	14
Installing the mud guards.....	15
Installing the rear wheels.....	16
Removing the rear wheels.....	16
Attaching the stroller seat.....	16
Removing the stroller seat.....	18
Attaching the canopy.....	19
Removing the canopy.....	20
Installing the shoulder harness pads.....	21
Installing the child arm bar.....	22
Removing the child arm bar.....	22
Attaching the under-seat storage basket.....	23

## STROLLER OPERATION

Using the brakes.....	25
Using the front wheel swivel lock.....	25
Adjusting the pivotal handle.....	26
Adjusting the leg rest.....	27
Adjusting the backrest.....	28
Securing your child in the harness.....	29
Adjusting the harness.....	31
Opening the harness.....	32
Adjusting the shoulder harness height.....	33
Using the tether strap.....	35
Using the stroller.....	36
Folding the stroller.....	37

# CONTENTS

---

## **STROLLER OPERATION**

Unfolding the stroller.....39  
Lifting and carrying the stroller.....40

## **BASSINET SECTION**

Bassinet Important Notes & Warnings.....42  
Bassinet Parts List.....43  
Bassinet Features.....44

## **BASSINET ASSEMBLY**

Assembling the bassinet.....45  
Attaching the boot cover.....46  
Removing the boot cover.....46

## **BASSINET OPERATION**

Attaching the bassinet to the stroller frame.....47  
Using the body band & D Ring attachments.....48  
Adjusting the canopy.....50  
Removing the bassinet from the stroller frame.....50  
Using the bassinet with the second seat.....51

## **SECOND SEAT SECTION**

Second Seat Important Notes & Warnings.....53  
Second Seat Parts List.....54  
Second Seat Features.....55

## **SECOND SEAT ASSEMBLY**

Installing the shoulder harness pads.....56

## **SECOND SEAT OPERATION**

Attaching the second seat to the stroller frame.....57  
Removing the second seat from the stroller frame.....60  
Adjusting the backrest.....61  
Securing your child in the harness.....62  
Adjusting the harness.....64  
Opening the harness.....65

# CONTENTS

---

## **SECOND SEAT OPERATION**

Adjusting the shoulder harness height.....65  
Folding the stroller with second seat.....67  
Using the second seat with the infant carrier.....69

## **INFANT CARRIER SECTION**

Infant Carrier Warnings & Important Notes.....72

## **INFANT CARRIER OPERATION**

Attaching the Unity Click & Go Infant Carrier to the stroller frame.....74  
Removing the Unity Click & Go Infant Carrier to the stroller frame.....75

**CARE AND MAINTENANCE** .....77

# WARNINGS

---

ALWAYS FOLLOW THE MANUFACTURERS INSTRUCTIONS.  
READ ALL INSTRUCTIONS CAREFULLY BEFORE ASSEMBLY AND USE OF  
THIS STROLLER.  
THE CORRECT USE AND MAINTENANCE OF THIS PRODUCT IS ESSENTIAL.

 **WARNINGS: TO AVOID INJURY OR DEATH:**  
**ALWAYS APPLY THE BRAKES WHENEVER THE STROLLER IS  
STATIONARY.**

- DO NOT LEAVE CHILDREN UNATTENDED.
- SECURE THE CHILD IN THE HARNESS AT ALL TIMES.
- DO NOT CARRY EXTRA CHILDREN OR BAGS ON THIS STROLLER.
- MAKE SURE CHILDREN ARE CLEAR OF ANY MOVING PARTS IF YOU ADJUST THE STROLLER.
- DO NOT USE ANY ACCESSORIES OTHER THAN THOSE APPROVED FOR USE WITH THIS STROLLER BY BRITAX.
- IT IS UNSAFE TO USE ACCESSORIES NOT APPROVED FOR USE WITH THIS STROLLER.
- THE MAXIMUM WEIGHT OF THE CHILD USING THIS STROLLER IS NOT TO EXCEED 20 KG, 9KG FOR THE BASSINET, 12KG FOR THE SAFE-N-SOUND UNITY NEOS OR SAFE-N-SOUND UNITY INFANT CARRIER ISOFIX COMPATIBLE CLICK & GO INFANT CARRIER OR 17KG FOR THE SECOND SEAT.

FOR IMPORTANT NOTES AND WARNINGS ON ACCESSORIES - REFER TO THEIR INDIVIDUAL SECTIONS IN THIS BOOK. THE MAXIMUM WEIGHT VARIES FOR EACH ACCESSORY.



**CAUTION**

This **CAUTION** Symbol is shown at certain steps in this Instruction Manual to highlight the danger of being injured by moving parts.

# IMPORTANT NOTES

---

- USE GREAT CARE WHEN USING THE STROLLER ON STAIRS, ESCALATORS, TRAVELATORS OR OTHER MOVING SURFACES.
- IT IS RECOMMENDED TO REMOVE THE CHILD FROM THE STROLLER BEFORE GOING UP OR DOWN STAIRS OR ESCALATORS.
- DO NOT LIFT THE STROLLER BY THE ARM BAR (Supplied) BECAUSE IT MAY DISENGAGE.
- DO NOT ALLOW CHILDREN TO STAND ON THE SEAT.
- DO NOT HANG BAGS OR GOODS FROM THE HANDLE AS THIS COULD CAUSE THE STROLLER TO TIP OVER.
- DO NOT LEAVE THE STROLLER AND ITS ACCESSORIES NEAR AN OPEN FIRE OR EXPOSED FLAME.
- DO NOT PLACE MORE THAN 4 KG IN THE BASKET, OR 1KG IN THE CANOPY POCKET (IF SUPPLIED).

# MANUAL HANDLING TECHNIQUES

---

## The **SMART** lifting technique

This technique can be used to pick up small light loads from low levels.

### **Size up the Load**

- Assess the load (size, shape and weight).
- Assess whether the load needs to be moved;
- Where is it going to be placed? Check that there are no obstructions;
- Assess whether mechanical or human assistance is required.

### **Move the Load as close to the body as possible**

- A load is heavier to lift or carry if it is not close to the body.
- The whole hand should be used to ensure a firm grip.

### **Always bend your knees**

- Maintain balance.
- Keep feet apart and in a comfortable position.
- Minimise lower back bending.
- Bend knees preferable at as large an angle as possible but not at a right angle - use a semi squat in preference to a full squat.

### **Raise the load with your legs**

- Achieve the lift smoothly and without jerkiness.
- Maintain the normal curvature of the spine to allow the force of the load to be distributed evenly from the spine to the pelvis.

### **Turn your feet in the direction that you want to move the load.**

- Avoid unnecessary bending, twisting and reaching.
- Change direction by turning your feet and not your back.
- To set the load down, squat down, keep your head up and let
- Let your legs do the work.

**Remember to 'THINK TALL' chest lifted, shoulders relaxed, chin tucked in and head level.**

# PARTS LIST

---

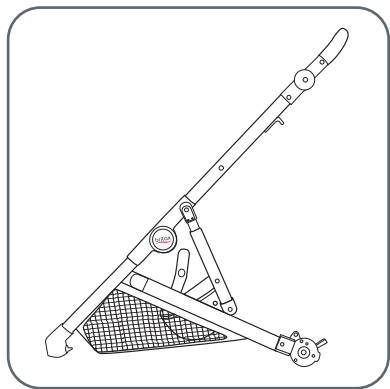

**1 x Stroller Frame & Basket**

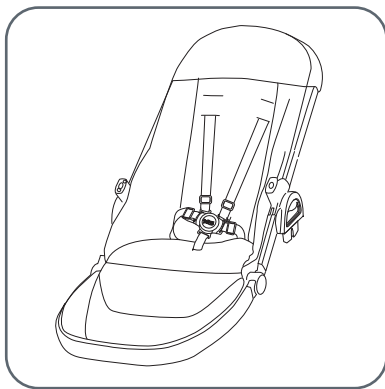

**1 x Stroller Seat**

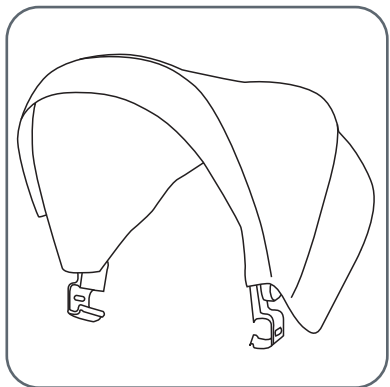

**1 x Canopy**

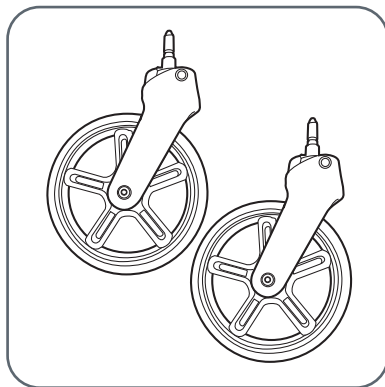

**2 x Front wheels**

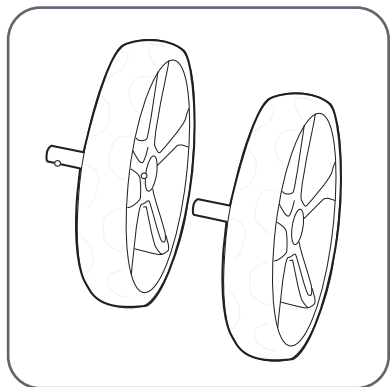

**2 x Rear wheels**

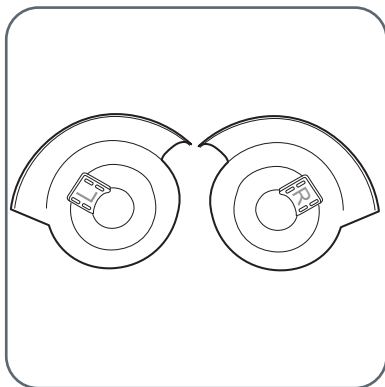

**2 x Mud Guards**



# PARTS LIST

---

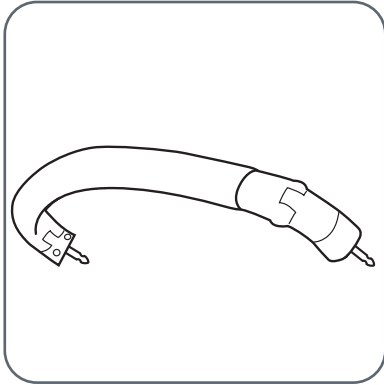

**1 x Arm bar**

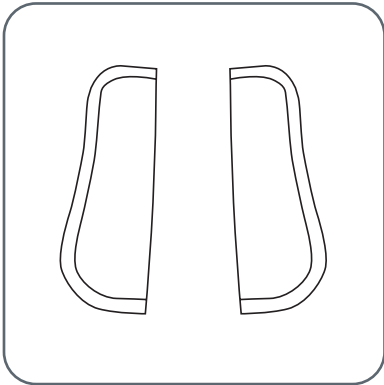

**1 x Set of Shoulder Harness Pads**

# STROLLER FEATURES

---

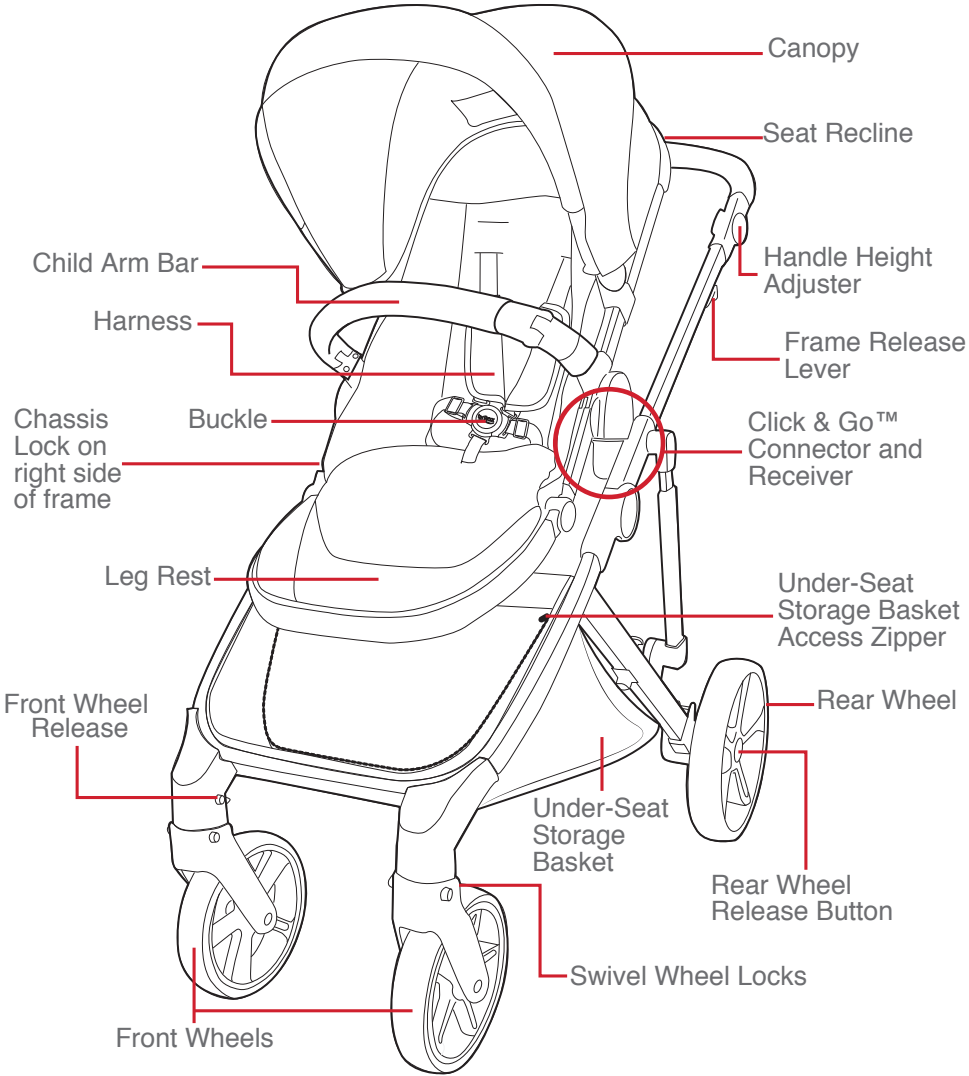

*Actual product may vary from images.*

# STROLLER CONFIGURATIONS

---

**PLEASE NOTE:** Shown with optional Accessories (**sold separately**).  
**DO NOT** exceed maximum weight limits defined in the infant carrier or accessory instruction manuals.

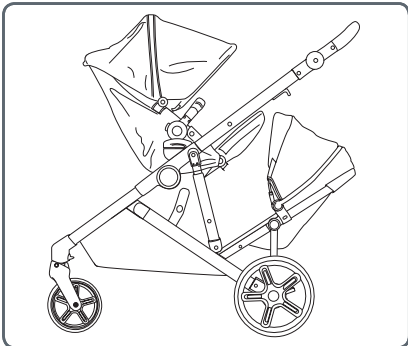
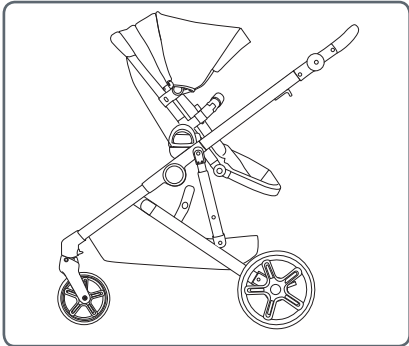
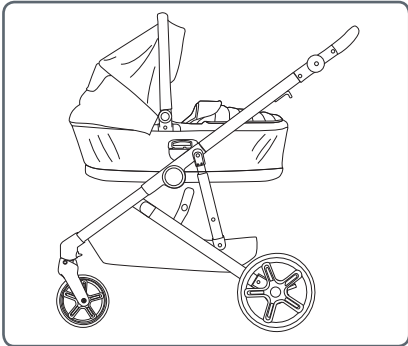
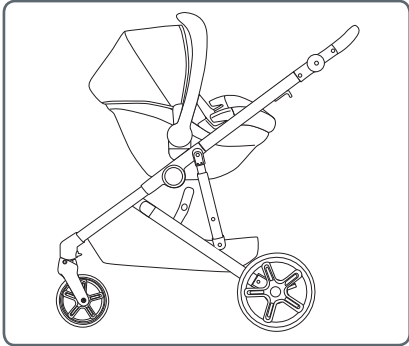
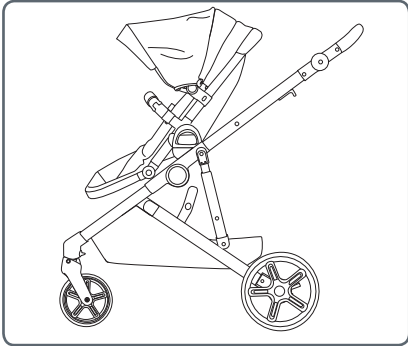

# STROLLER CONFIGURATIONS

---

The following configurations require the use of the extension adapters (**supplied with the second seat**):

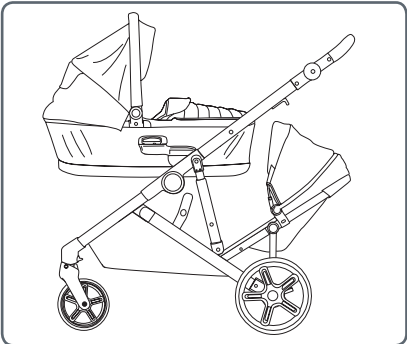
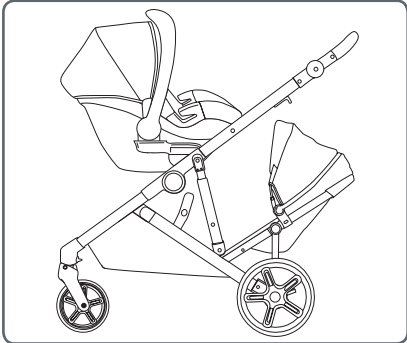
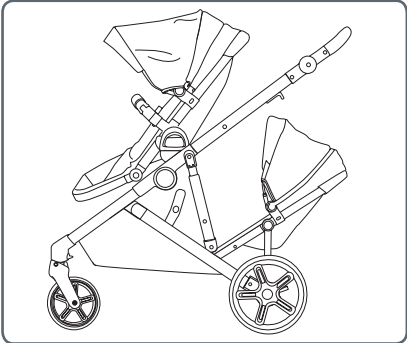

# STROLLER ASSEMBLY

---

## IMPORTANT NOTES:

PLEASE REFER TO PAGE 7 FOR SMART LIFTING TECHNIQUES.

- RELEASE THE STORAGE LATCH WITH DUE CARE AND OPEN THE FRAME.
- WHEN OPENING THE STROLLER, BE AWARE OF THE DANGER OF BEING INJURED BY MOVING PARTS AND LOCKING DEVICES DURING THE PROCESS. KEEP ALL HANDS AND LIMBS CLEAR OF THESE PARTS.
- THERE IS POTENTIAL FOR FINGERS OR PARTS OF THE BODY TO BE INJURED WHEN THE STROLLER IS BEING UNFOLDED, DUE CARE SHOULD BE EXERCISED.
- KEEP CHILDREN CLEAR OF THE STROLLER WHEN UNFOLDING THE STROLLER.
- OPEN THE STROLLER SLOWLY AND BE CAREFUL WHERE YOU PLACE YOUR HANDS. KEEPING YOUR HANDS ON THE HANDLE IS THE BEST WAY TO UNFOLD THE STROLLER.

## OPENING THE STROLLER FRAME

- A** Push the release on the chassis lock and open the frame.

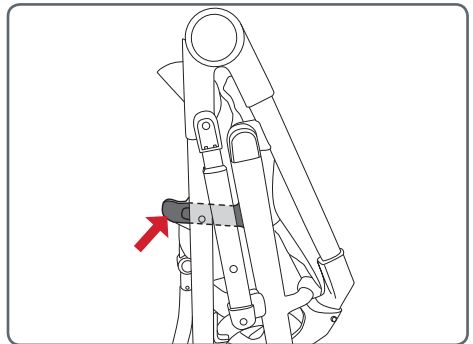

# STROLLER ASSEMBLY

## OPENING THE STROLLER FRAME

- B** Lift handle until frame locks into upright position.

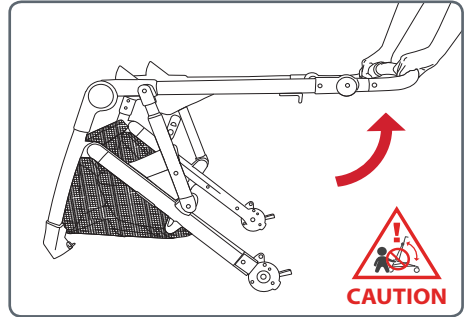

## INSTALLING THE FRONT WHEELS

- A** Slide front wheel mounting pins into the housings on the frame until they lock into place.
- B** Pull on both front wheels to ensure they are locked into the frame housings.

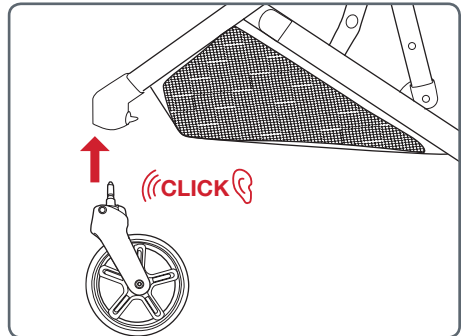

## REMOVING THE FRONT WHEELS

- A** Press and hold the release button on the inner side of the front wheel housing and pull the wheel from the stroller.

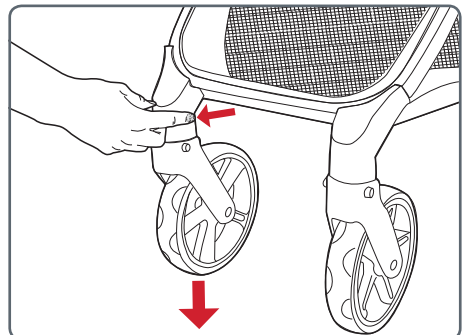

# STROLLER ASSEMBLY

---

## INSTALLING THE MUD GUARDS

**PLEASE NOTE:** The mud guards are marked 'L' (LEFT) and 'R' (RIGHT) for correct fitting.

- A** Slide the mud guard onto the mounting bracket above each rear wheel housing and push down until it locks into place.

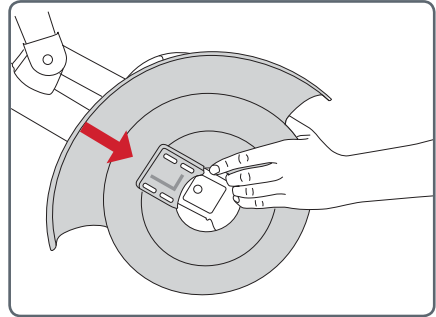

## INSTALLING THE REAR WHEELS

- A** Hold in the release button in the centre of the wheel and slide the mounting pin into the housing on the rear axle.
- B** Pull on both rear wheels to ensure they are locked into the frame housings.

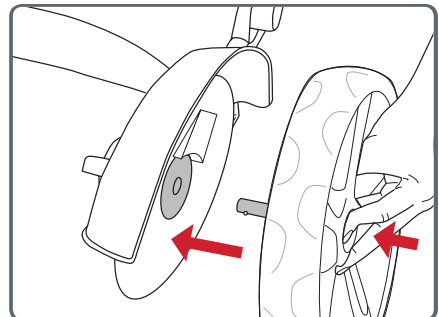

# STROLLER ASSEMBLY

---

## REMOVING THE REAR WHEELS

- A** Press and hold the release button in the centre of the wheel and pull away from the wheel housing.

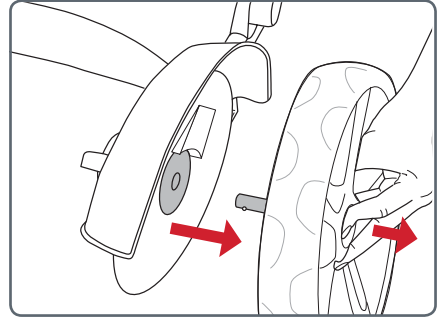

## ATTACHING THE STROLLER SEAT

### IMPORTANT NOTE:

**ALWAYS REMOVE YOUR CHILD FROM THE STROLLER SEAT BEFORE INSTALLING, REMOVING OR CHANGING THE SEAT DIRECTION.**

**PLEASE NOTE:** The seat is reversible so it can be attached to the frame in the forward facing position or the rearward facing position.

- A** Step on the brake pedal until the indicator window changes to red.

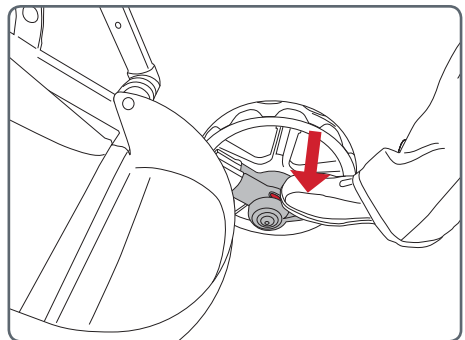



# STROLLER ASSEMBLY

## ATTACHING THE STROLLER SEAT

- B** Insert the Click & Go Connectors on the stroller seat into the Click & Go receivers on the frame.

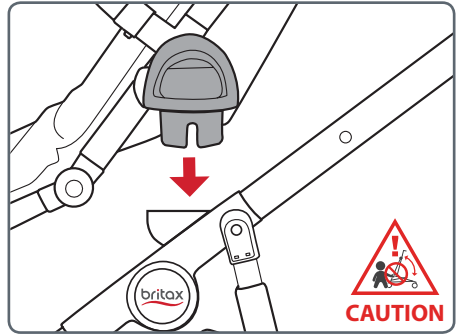

- C** Push down on the seat until a 'click' is heard which indicates the connector has locked into the receiver.

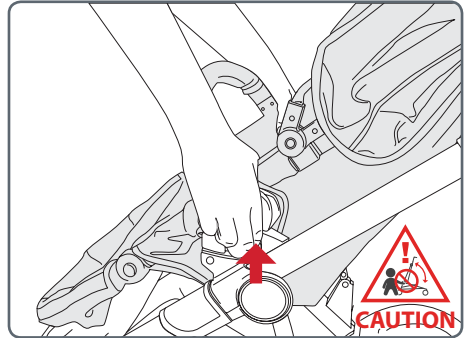

- D** Pull up on both sides of the seat to ensure that it is locked into place correctly.

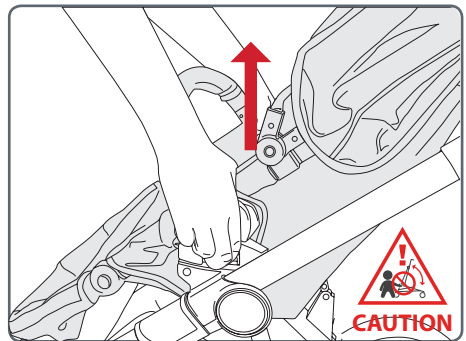

# STROLLER ASSEMBLY

---

## REMOVING THE STROLLER SEAT

### IMPORTANT NOTE:

ALWAYS REMOVE YOUR CHILD FROM THE STROLLER SEAT BEFORE INSTALLING, REMOVING OR CHANGING THE SEAT DIRECTION.

- A** Lift both release levers on the Click & Go connectors at the same time.

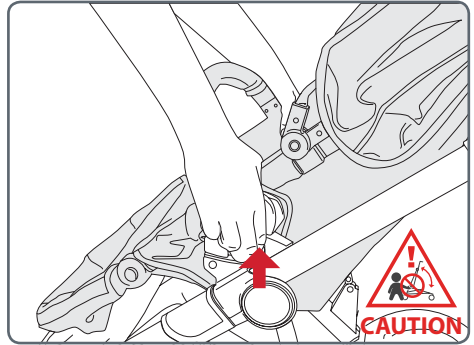

- B** Lift the seat up and away from the stroller frame.

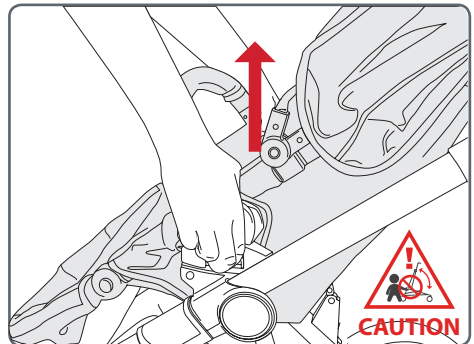

# STROLLER ASSEMBLY

---

## ATTACHING THE CANOPY

### IMPORTANT NOTE:

The sun is very strong. **DO NOT LEAVE YOUR CHILD EXPOSED TO THE SUN.** The canopy or hood on this product will not give your child total protection from the harmful rays of the sun.

- A** Push the canopy clips onto each side of the stroller frame until they interlock with the canopy lock on the stroller frame.

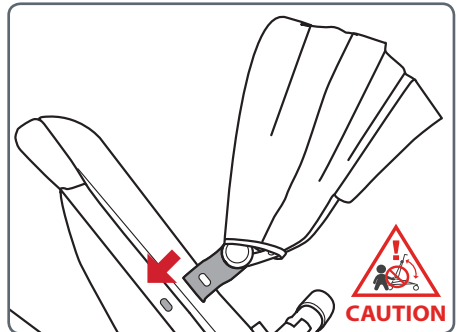

- B** Zip the canopy onto the stroller.

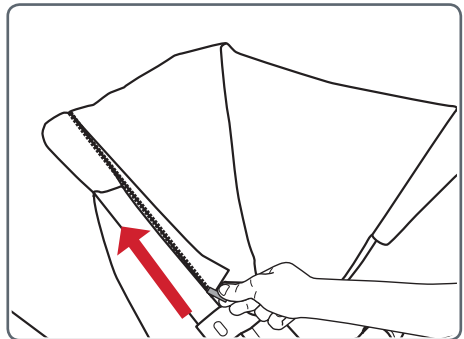

- C** Open the canopy by pulling forward or close by pushing it backward.
- D** To access the peek a boo window on the canopy, lift the cover & place over the centre bow.

# STROLLER ASSEMBLY

---

## REMOVING THE CANOPY

**A** Fully unzip the canopy from the stroller frame.

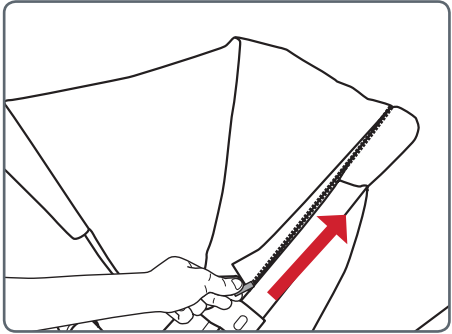

**B** Pull the canopy clips onto each side of the stroller frame until they are released from the canopy lock on the stroller frame.

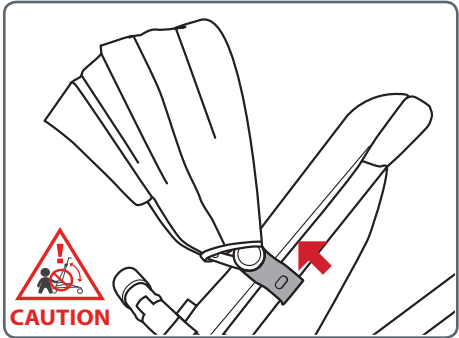

# STROLLER ASSEMBLY

---

## INSTALLING THE SHOULDER HARNESS PADS

### IMPORTANT NOTE:

ENSURE THAT THE SHOULDER STRAPS ARE FITTED THROUGH THE APPROPRIATE HARNESS SLOTS TO SUIT YOUR CHILD'S SEATED SHOULDER HEIGHT.

- A** Release the harness buckles (Refer to Page 32) and slide the shoulder harness pads onto the shoulder harness straps.

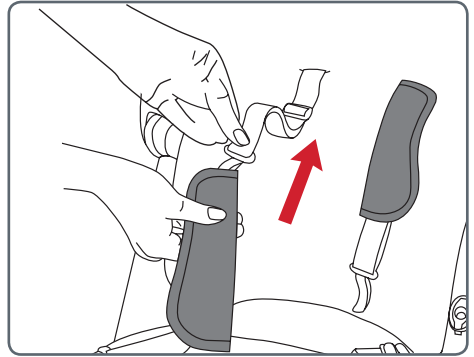

# STROLLER ASSEMBLY

## INSTALLING THE CHILD ARM BAR

### IMPORTANT NOTE:

**WHEN A CHILD IS IN THE STROLLER, KEEP THE CHILD ARM BAR ATTACHED AT ALL TIMES.**

- A** Align the pins on each side of the arm bar with the mounts on the seat and slide the arm bar pins into the housing on the seat until a 'click' is heard which indicates the pins have locked in.
- B** Pull up on the child arm bar to ensure that it is locked into place correctly.

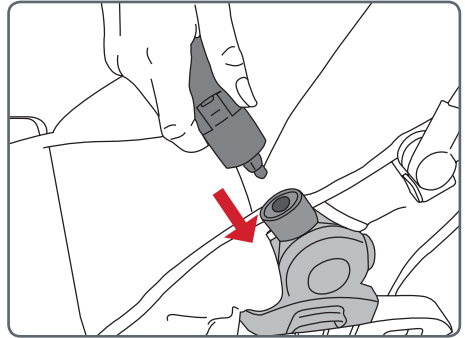

## REMOVING THE CHILD ARM BAR

### IMPORTANT NOTE:

**THE ARM BAR CAN BE OPENED FROM EITHER SIDE OF THE SEAT WITHOUT REMOVING.**

- A** To assist with putting a child in the stroller you can release the arm bar on one side. Press the button underneath the seat connector and pull the arm bar forward. Rotate the arm bar clear of the stroller. Reattach the arm bar after fastening the child in the harness.

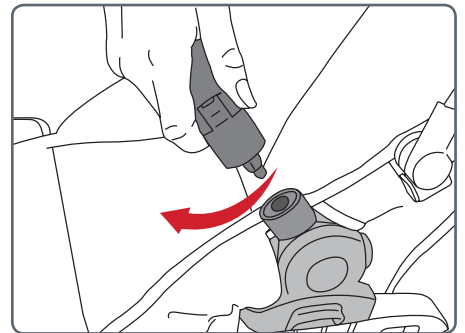

# STROLLER ASSEMBLY

---

## REMOVING THE CHILD ARM BAR

- B** Press the buttons underneath the seat connectors on both sides of the stroller seat and pull the arm bar out of the mounts to remove.

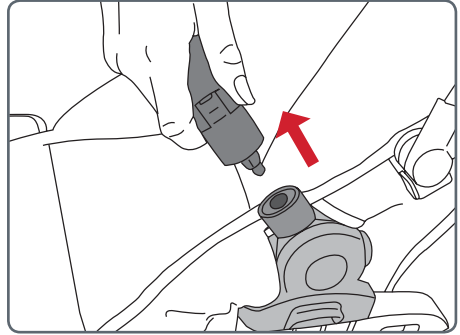

## ATTACHING THE UNDER-SEAT STORAGE BASKET

**PLEASE NOTE:** The under-seat storage basket is only partially attached to the stroller frame. Follow the steps below to fully attach the basket.

- A** Fold the back of the storage basket out from within the basket and turn inside out for proper orientation.

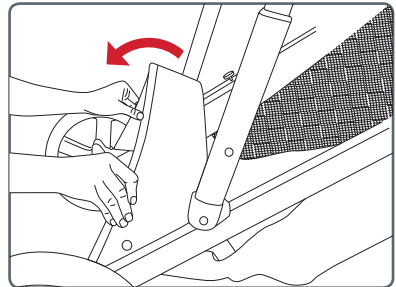

- B** Slide the hook on each side of the storage basket into the slots on the stroller frame near the rear wheels.

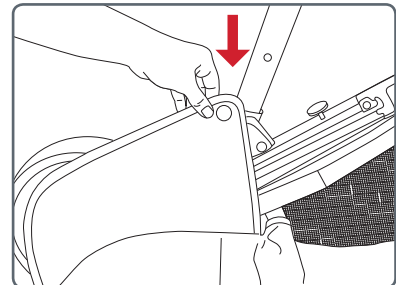

**IMPORTANT:** Ensure the hooks are fully retained in their respective slots before using the storage basket.

# STROLLER ASSEMBLY

---

## ATTACHING THE UNDER-SEAT STORAGE BASKET

**C** The back of the storage basket can be unzipped and removed for accessibility and maintenance.

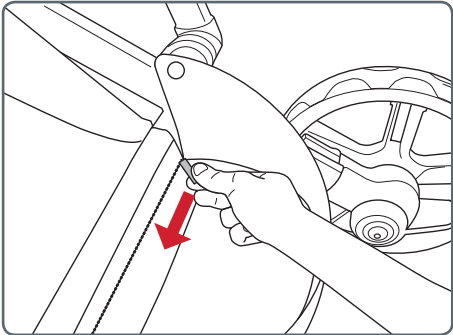



# STROLLER OPERATION

---

## USING THE BRAKES

**!** **WARNINGS:** ALWAYS APPLY THE BRAKES WHEN THE STROLLER IS STATIONERY.

**PLEASE NOTE:** Pressing the brake locks both rear wheels.

- A** To engage, step on the brake pedal until the indicator window changes to red.
- B** To disengage, step on the brake pedal until the indicator window changes to green.

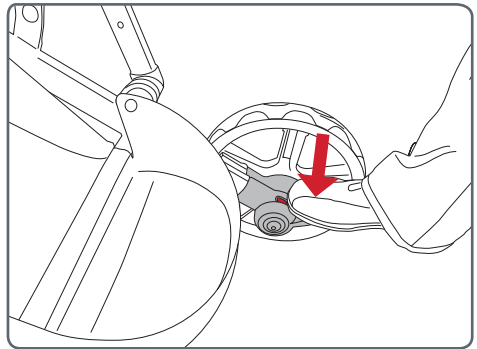

## USING THE FRONT WHEEL SWIVEL LOCK

**PLEASE NOTE:** Always lock the swivel wheels when using the stroller on rough surfaces as it will minimise wheel wobble.

You may need to swivel the wheels to the proper position to engage the swivel lock

- A** Push the swivel lock up to allow the wheels to swivel.

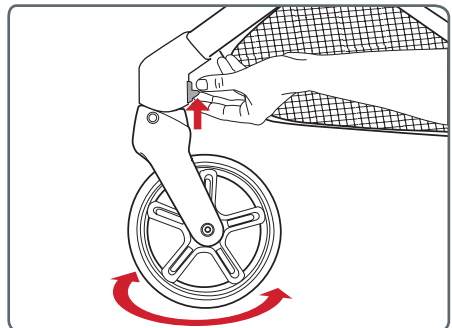

# STROLLER OPERATION

---

## USING THE FRONT WHEEL SWIVEL LOCK

- B** Push the swivel lock down to lock the wheels.

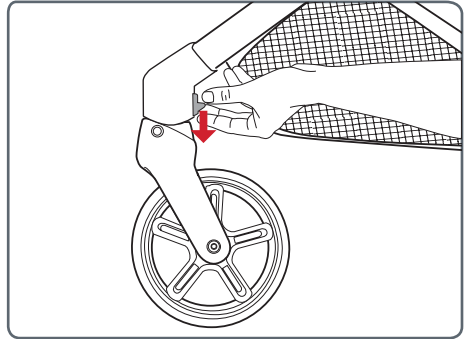

## ADJUSTING THE PIVOTAL HANDLE

- A** Press the two release buttons on the inside of the handle assembly and hold while raising or lowering the handle to the desired position.

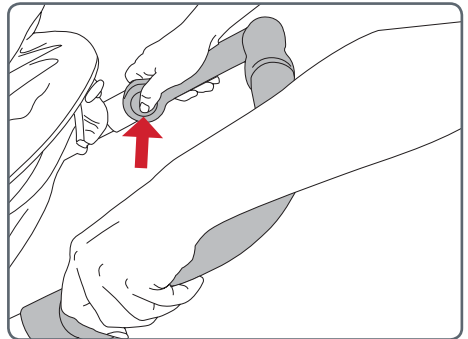

# STROLLER OPERATION

---

## ADJUSTING THE LEG REST

### IMPORTANT NOTE:

- THE LEG REST FEATURE IS PROVIDED FOR YOUR CHILDS COMFORT.
- THE LEG REST IS NOT DESIGNED TO SUPPORT EXTRA WEIGHT.
- DO NOT ALLOW CHILDREN TO STAND OR SIT ON THE LEG REST. IT WILL DISENGAGE IF EXTRA WEIGHT IS APPLIED.
- IF LEG REST DISENGAGES SIMPLY LIFT UP AGAIN TO RESET LEG REST MODE

**A** Press the two release buttons on both sides of the leg rest hinge and hold while raising or lowering the leg rest to the desired position.

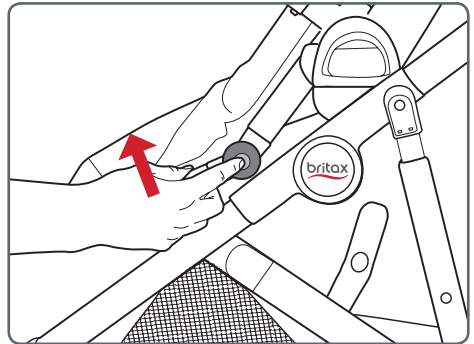

# STROLLER OPERATION

---

## ADJUSTING THE BACKREST

### **WARNINGS:**

- THE UPRIGHT POSITIONS ARE NOT SUITABLE FOR USE WITH CHILDREN LESS THAN 6 MONTHS OLD.
- THE LOWEST RECLINE POSITION SHOULD BE USED TO TRANSPORT BABIES. THE BACKREST CAN BE ADJUSTED TO A MORE UPRIGHT POSITION AS THE CHILD GROWS OLDER AND IS ABLE TO SUPPORT ITS HEAD WITHOUT ASSISTANCE.

**PLEASE NOTE:** If the child is sitting in the seat, support the backrest as it reclines. If you have difficulty adjusting the backrest you may need to remove the child from the seat to allow you to raise or lower the backrest with ease.

- A** Lift the recline lever on the back of the seat and hold while raising or lowering the backrest to the desired position.

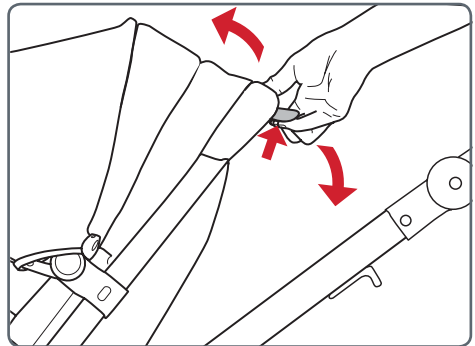

# STROLLER OPERATION

## SECURING YOUR CHILD IN THE HARNESS

**⚠ WARNING:** USE THE HARNESS AT ALL TIMES.

- ENSURE YOUR CHILD IS SECURED WITH A CORRECTLY ADJUSTED HARNESS.
- THE ADJUSTED HARNESS SHOULD CLOSELY FIT THE CHILD.
- NEVER LEAVE THE HARNESS BUCKLED WHEN NOT FITTED TO A CHILD IN THE STROLLER, BECAUSE THE HARNESS CAN FORM LOOPS WHICH MAY POSE A STRANGULATION HAZARD.
- WHEN HARNESS IS NOT IN USE, DISCONNECT SHOULDER STRAPS FROM THE WAIST STRAPS AND BUCKLE TO PREVENT STRANGULATION.
- A five point harness is provided to restrain your child.
- Buckle tongues separate for added safety.
- To reconnect buckle tongues and to secure the child in the harness please follow the steps below carefully.

**PLEASE NOTE:** Each waist buckle tongue has a raised rib on one side and can only be locked into the buckle assembly with the raised rib facing up. Ensure the harness straps are not twisted as they may become uncomfortable for the child.

- A** Always apply the brakes.  
Place child in stroller seat.  
Position the shoulder strap near the child's shoulder.  
Position crotch strap between legs.  
Thread the waist strap buckle tongues through the shoulder straps tongue guides.

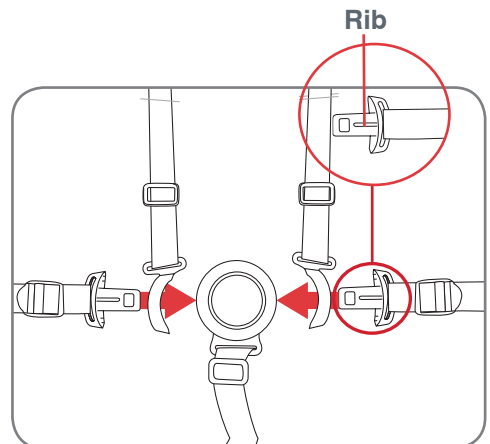

# STROLLER OPERATION

---

## SECURING YOUR CHILD IN THE HARNESS

- B** Hold the centre button in on the crotch buckle and insert the waist buckle tongues into the crotch strap buckle until you hear a 'click'.

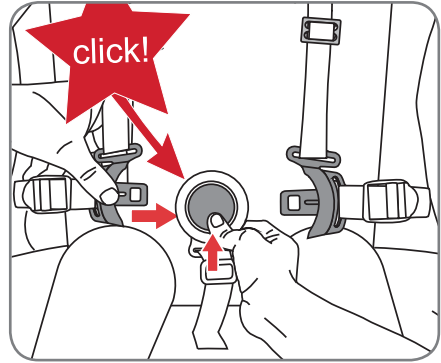

- C** Repeat the procedure on the other side.

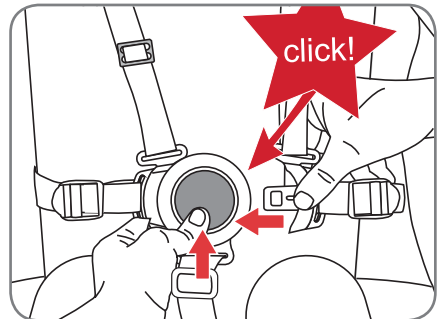

**IMPORTANT:** Pull on each waist buckle tongue to make sure they are locked into the crotch buckle assembly. If not, repeat above procedure.

# STROLLER OPERATION

## ADJUSTING THE HARNESS

- A** Tighten or loosen the shoulder straps and crotch strap by sliding the 3 bar harness adjuster up or down. The crotch strap should be adjusted to a snug fit.

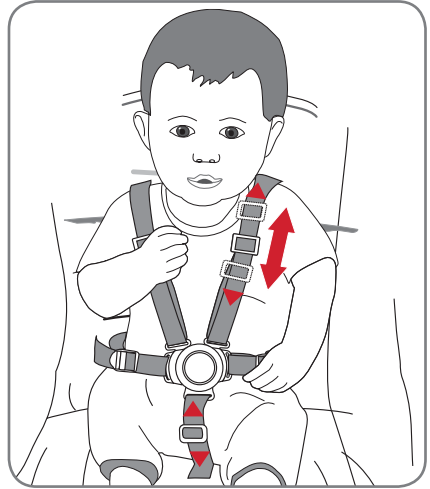

**!** **CAUTION:** DO NOT SLIDE 3 BAR SLIDER OVER THE SEWN TAB ON SHOULDER HARNESS.

- B** Tighten or loosen the waist straps, hold and lift the 4 bar harness adjuster and pull the harness strap to adjust to the desired fit. The waist strap needs to fit firmly around the child.

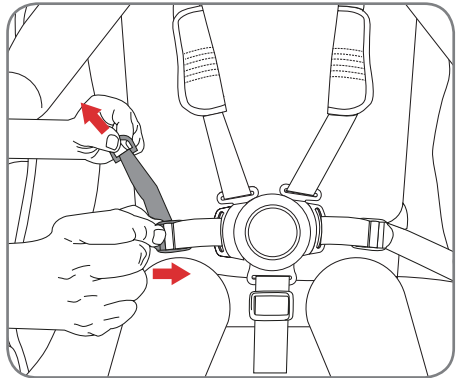

# STROLLER OPERATION

---

## OPENING THE HARNESS

- A** Release the harness by pressing the centre button in on the crotch buckle while pulling the waist tongues out of the crotch buckle.

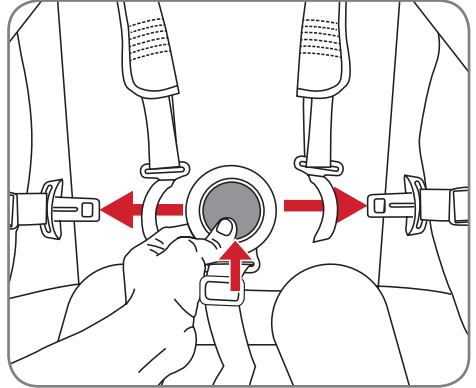

## ADJUSTING THE SHOULDER HARNESS HEIGHT

### IMPORTANT NOTE:

**THE HARNESS CAN BE ADJUSTED TO THREE DIFFERENT HEIGHTS TO ACCOMMODATE THE CHILD. THE SHOULDER STRAPS MUST BE POSITIONED NEAR THE CHILD'S SHOULDERS.**

- A** Open the zipper on the seat back to access the harness strap retainers.

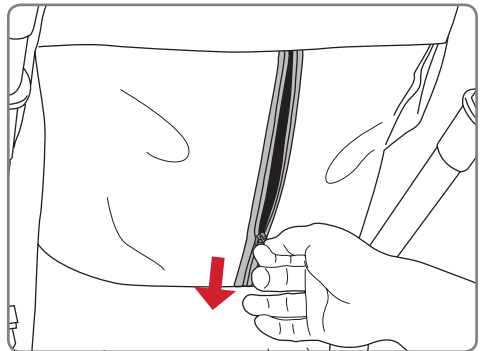



# STROLLER OPERATION

---

## ADJUSTING THE SHOULDER HARNESS HEIGHT

- B** Pull each harness strap retainer clip away from the seat back and turn 90 degrees to feed it through the harness slot.

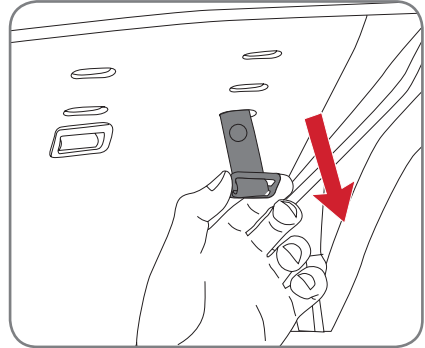

- C** Push each harness retainer through the harness slot to the front of the seat.

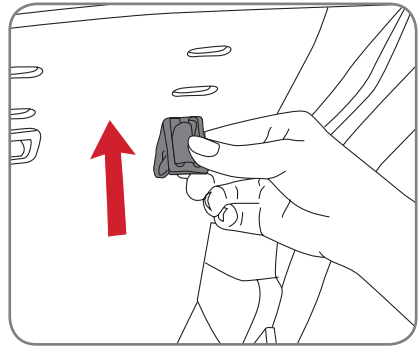

- D** Select the appropriate harness slot and push each harness retainer through to the back of the seat.

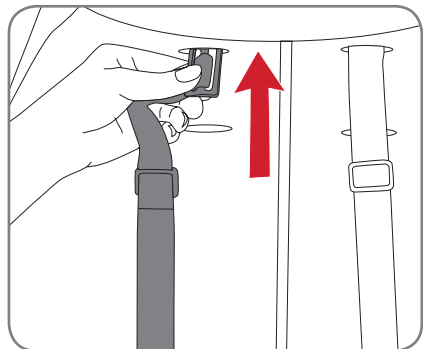

# STROLLER OPERATION

---

## ADJUSTING THE SHOULDER HARNESS HEIGHT

**E** Pull each harness strap retainer through the harness slot.

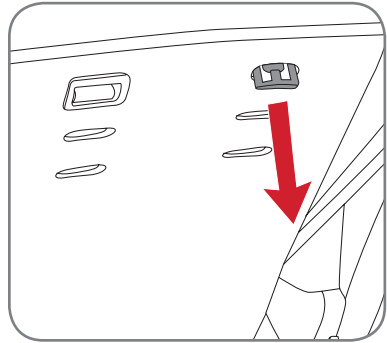

**F** Turn each harness retainer 90 degrees to its original position as shown. The harness retainers should sit flat against the backrest to ensure it is properly secured.

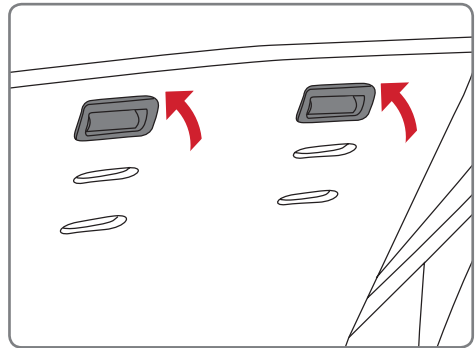

**G** Close the zipper on the seat back.

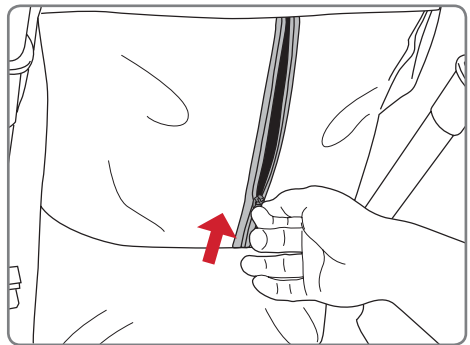

# STROLLER OPERATION

---

## USING THE TETHER STRAP

**⚠ WARNINGS:** USE THE TETHER STRAP TO STOP THE STROLLER ROLLING AWAY.

- THE STROLLER IS DESIGNED FOR USE ON FLAT OR GENTLY SLOPING SURFACES, AND MAY BE UNSTABLE ON HIGHER SLOPING AND UNEVEN SURFACES AND USERS SHOULD BE AWARE OF THE POSSIBILITY OF THE STROLLER ROLLING AWAY OR TIPPING OVER.
- NEVER LET GO OF THE STROLLER WHEN PARKED ON AN INCLINE OR SLOPING SURFACE BECAUSE IT MAY SLIDE OR TIP OVER. ALWAYS PARK ON A FLAT SURFACE AND APPLY THE BRAKES.
- ALWAYS APPLY THE BRAKES WHENEVER THE STROLLER IS STATIONARY.

**A** A wrist tether strap is provided on the handle grip. Slide your hand through the tether strap loop whenever you use the stroller. Only remove your hand from the tether strap loop when the brakes have been applied to the stroller wheels.

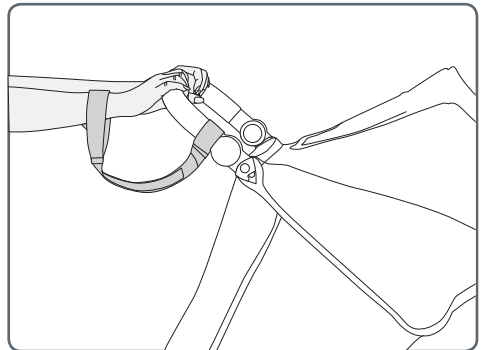

# STROLLER OPERATION

---

## USING THE STROLLER

### **PLEASE REFER TO PAGE 7 FOR LIFTING TECHNIQUES.**

- Always ensure you bend your knees where appropriate and take due care when lifting the frame.
- With your hand through the wrist tether strap loop, push the stroller holding the handle.
- The stroller can be steered in the desired direction - allowing the front wheels to swivel will make this easier.
- The front wheels may wobble or oscillate when walking fast. Locking the front swivel wheels will stop this.
- The stroller can be taken up kerbs by either pressing down on the handles and raising the front wheels or turning the stroller around and pulling the stroller up the kerb.
- Caution is required when pushing the stroller on a steep slope as the stroller may become unstable. Always hold the handles firmly.
- Do not run with the stroller.
- Whenever you stop, always apply the brakes before you leave the stroller.
- Do not hang bags or goods from the handle. Use the storage basket.

# STROLLER OPERATION

---

## FOLDING THE STROLLER

PLEASE REFER TO PAGE 7 FOR LIFTING TECHNIQUES.

- REMOVE THE CHILD FROM THE STROLLER BEFORE COMMENCING ANY FOLDING OPERATION.
- FOLD THE STROLLER SLOWLY AND BE CAREFUL WHERE YOU PLACE YOUR HANDS.
- WHEN FOLDING THE STROLLER, BE AWARE OF THE DANGER OF BEING INJURED BY MOVING PARTS AND LOCKING DEVICES DURING THE PROCESS. KEEP ALL HANDS AND LIMBS CLEAR OF THESE PARTS.
- THERE IS POTENTIAL FOR FINGERS OR PARTS OF THE BODY TO BE INJURED WHEN THE STROLLER IS BEING FOLDED, DUE CARE SHOULD BE EXERCISED.
- KEEP CHILDREN CLEAR OF THE STROLLER DURING FOLDING THE STROLLER.

**PLEASE NOTE:** It is recommended to remove the stroller seat from the frame (Refer to Page 18) before folding.

- A** Remove the child from the stroller.
- B** Lock the brakes. (Refer to Page 25)
- C** Lock the swivel wheels. (Refer to Page 26)
- D** Close the canopy. (Refer to Page 19)
- E** Raise the backrest to the fully upright position. (Refer to Page 28)
- F** Adjust the leg rest to the lowest position. (Refer to Page 27)
- G** Adjust the pivotal handle to the highest position. (Refer to Page 26)

# STROLLER OPERATION

## FOLDING THE STROLLER

- H Pull up both frame release levers located just below the stroller handle, and step back while guiding stroller downwards.

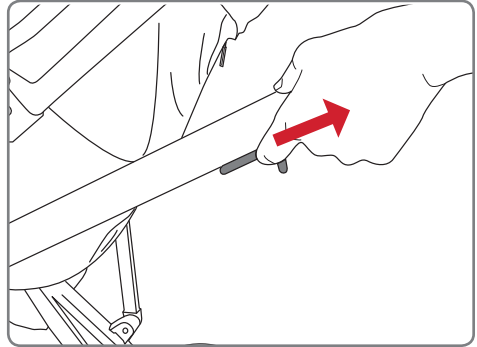

- I Continue folding until the chassis lock engages. You may need to compress the frame to engage the chassis lock

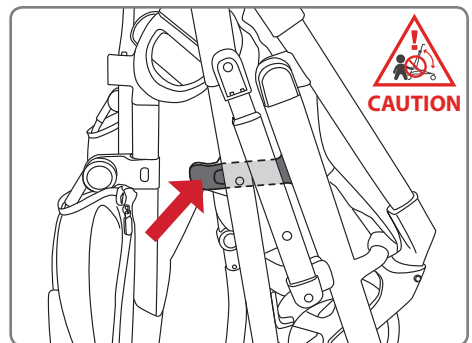
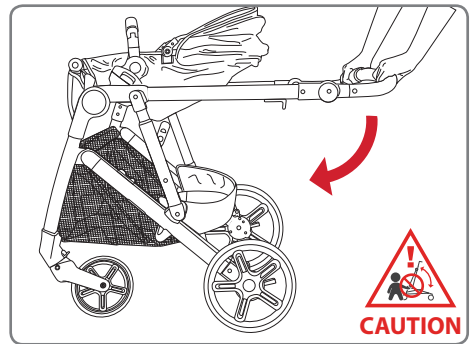

# STROLLER OPERATION

## UNFOLDING THE STROLLER

**A** Push the release on the chassis lock and open the frame.

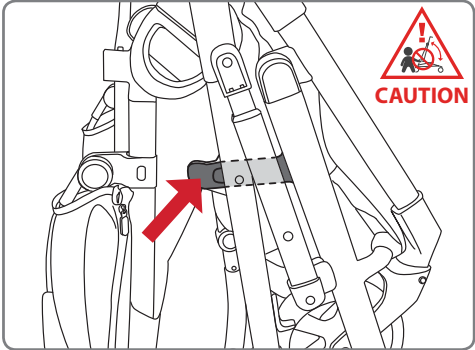

**B** Lift the handle until the frame locks into upright position.

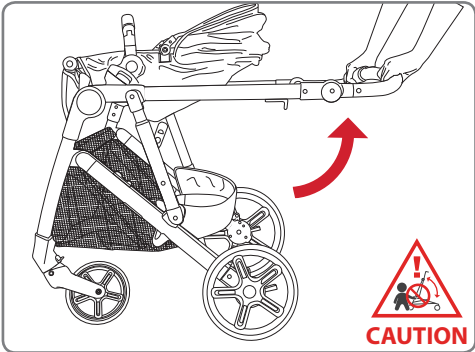

# STROLLER OPERATION

---

## LIFTING AND CARRYING THE STROLLER

### IMPORTANT NOTES:

PLEASE REFER TO PAGE 7 FOR SMART LIFTING TECHNIQUES.

- **TO AVOID INJURY: BEND YOUR KNEES WHEN OPENING, LIFTING, CARRYING, FOLDING, UNFOLDING OR ADJUSTING THE STROLLER OR ANY ACCESSORIES.**

**A** Ensure the chassis lock is engaged on the frame before lifting the stroller. To lift the stroller, grasp the frame halfway along the stroller, so the stroller is balanced.



**britax**

**B-READY®  
BASSINET**



Serial No. P8310

# WARNINGS

---

**ALWAYS FOLLOW THE MANUFACTURERS INSTRUCTIONS.  
READ ALL INSTRUCTIONS CAREFULLY BEFORE ASSEMBLY AND USE OF  
THIS BASSINET.  
THE CORRECT USE AND MAINTENANCE OF THIS PRODUCT IS ESSENTIAL.**

## **WARNINGS:**

- **DO NOT USE THE BASSINET ONCE THE CHILD CAN SIT UP.**
- **SECURE THE CHILD IN THE HARNESS AT ALL TIMES.**
- **DO NOT USE ANY ACCESSORIES OTHER THAN THOSE APPROVED FOR USE WITH THIS STROLLER BY BRITAX.**
- **IT IS UNSAFE TO USE ACCESSORIES NOT APPROVED FOR USE WITH THIS STROLLER.**
- **THE MAXIMUM WEIGHT OF THE CHILD USING THIS BASSINET IS NOT TO EXCEED 9KG FOR THE BASSINET.**

## **IMPORTANT NOTES**

---

- **THE B-READY BASSINET IS THE ONLY BASSINET DESIGNED TO FIT THE B-READY STROLLER.**
- **REMOVE THE STROLLER SEAT OR INFANT CARRIER FROM THE STROLLER FRAME BEFORE FITTING THE BASSINET.**
- **ALWAYS REMOVE YOUR CHILD FROM THE BASSINET BEFORE INSTALLING ON OR REMOVING FROM THE STROLLER FRAME.**
- **THE BASSINET MUST ALWAYS FACE TOWARDS THE HANDLE. THE BASSINET CAN BE USED IN THE FORWARD FACING POSITION WITH THE USE OF THE EXTENSION ADAPTERS.**
- **THE BASSINET MUST BE REMOVED FROM THE FRAME BEFORE FOLDING.**
- **DO NOT LIFT THE STROLLER BY THE BASSINET.**

# PARTS LIST

---

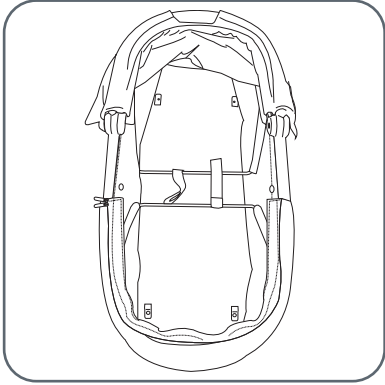

**1 x Bassinet frame**

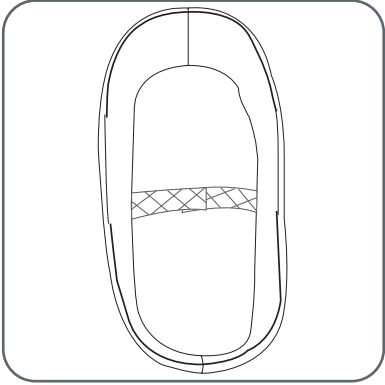

**1 x Bassinet liner**

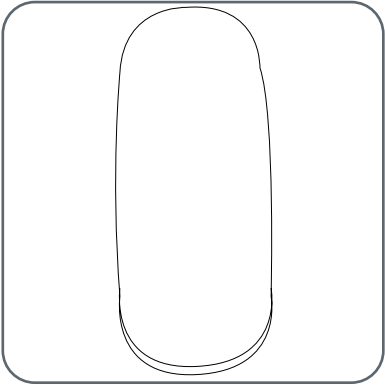

**1 x Bassinet mattress**

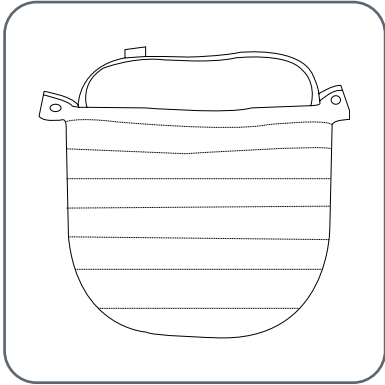

**1 x Bassinet boot cover**

# BASSINET FEATURES

---

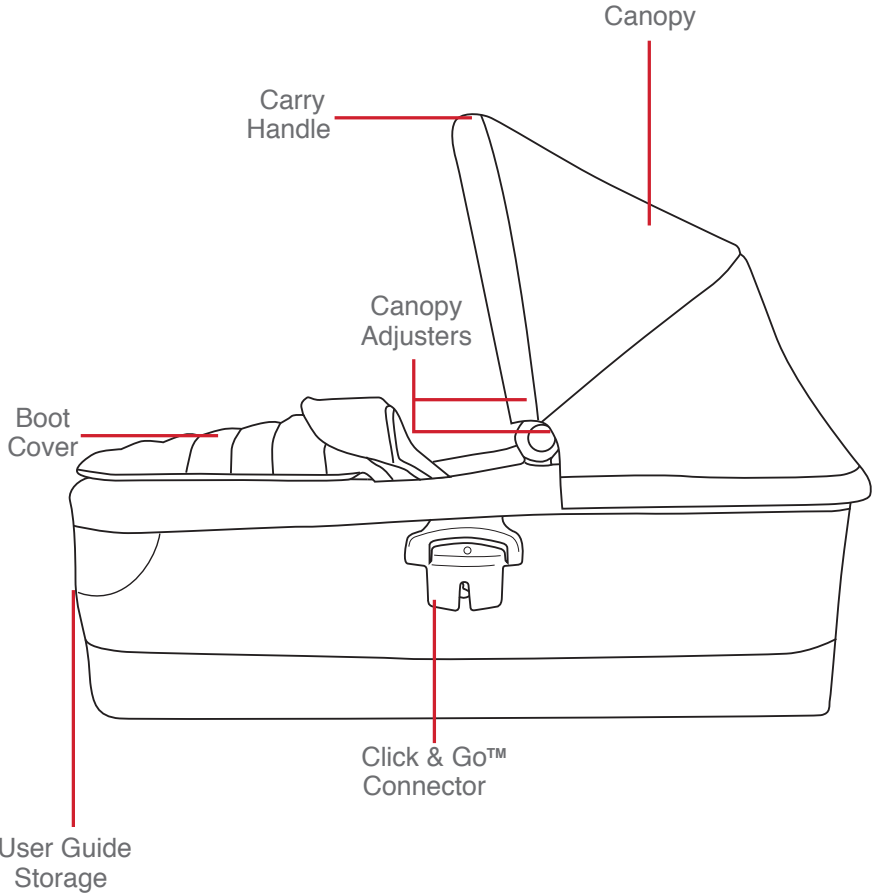

# BASSINET ASSEMBLY

## ASSEMBLING THE BASSINET

PLEASE REFER TO PAGE 7 FOR SMART LIFTING TECHNIQUES.

**A** Pull the frame supports outward by the straps until they lock under all 4 clips. Push down lightly on the top edges of the carry cot to ensure that the frame support rods are firmly locked in place.

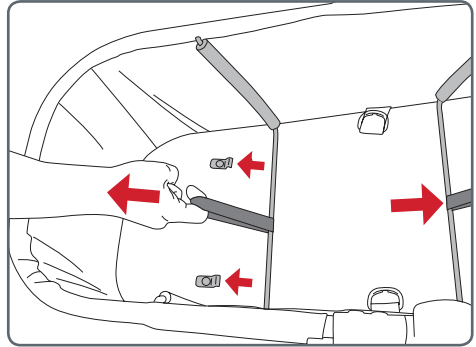

**B** Place the fabric liner into the bassinet. Ensure the body band is laying on the surface of the liner.

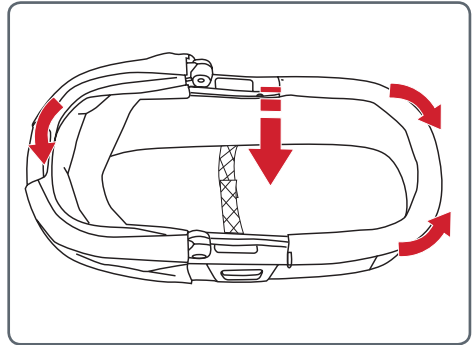

**C** Zip the fabric liner around the bassinet frame.

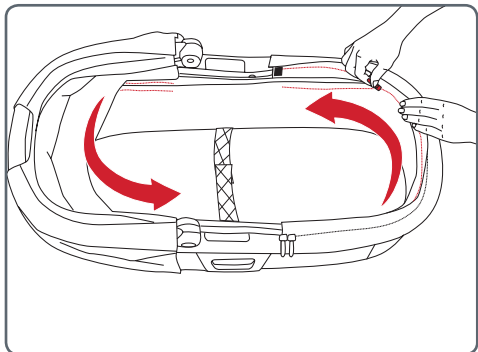

# BASSINET ASSEMBLY

---

## ASSEMBLING THE BASSINET

- D Place the mattress into the bassinet and place the body band on the top surface of the mattress.

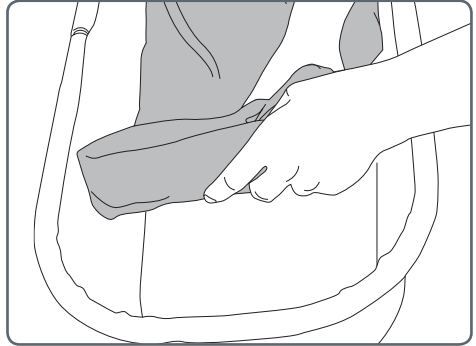

## ATTACHING THE BOOT COVER

- A Zip the boot cover onto the bassinet.

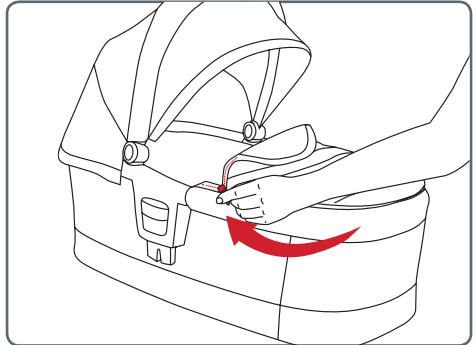

## REMOVING THE BOOT COVER

- A Unzip and remove the boot cover.

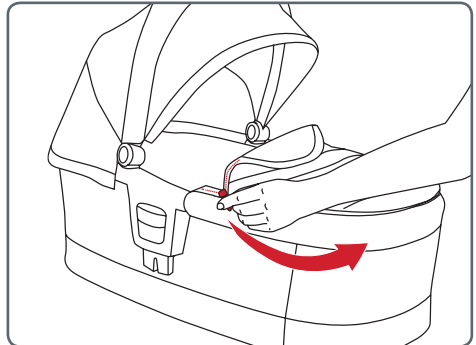

# BASSINET OPERATION

---

## ATTACHING THE BASSINET TO THE STROLLER FRAME

PLEASE REFER TO PAGE 7 FOR SMART LIFTING TECHNIQUES.

**PLEASE NOTE:** The bassinet can be used in the forward facing position with the use of extension adapters.

**A** Engage the stroller brake. (Refer to Page 25)

Align the bassinet Click & Go connectors with the Click & Go receivers on the stroller frame.

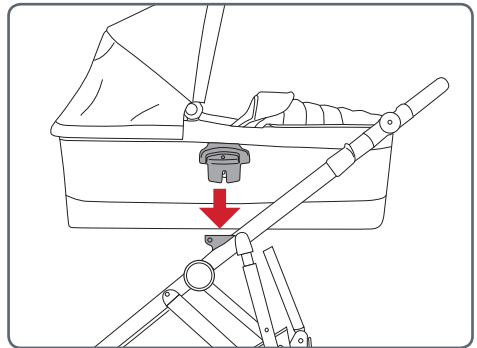

**B** Push down on the bassinet until a 'click' is heard which indicates the connectors have locked into the receivers.

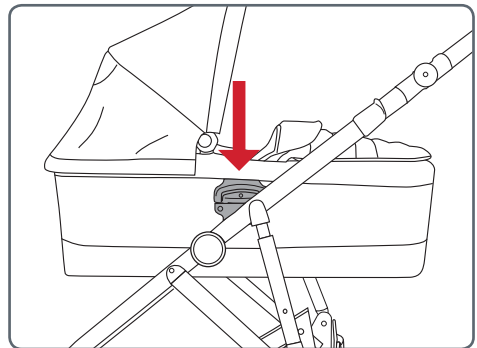

# BASSINET OPERATION

---

## ATTACHING THE BASSINET TO THE STROLLER FRAME

- C** Gently pull up on the bassinet canopy handle to ensure it is locked into place.

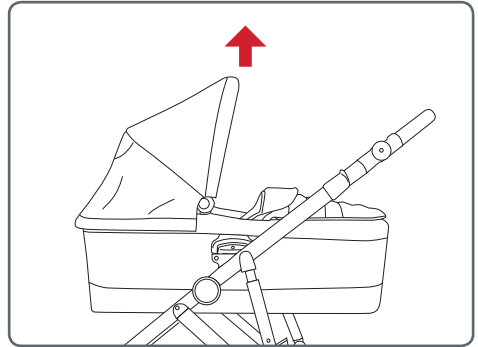

## USING THE BODY BAND & D-RING ATTACHMENTS

### IMPORTANT NOTE:

**A BODY BAND IS ATTACHED TO THE BASSINET LINER AND IS FOR OPTIONAL USE.**

- A** Place your baby in the bassinet. Place the baby band around your baby's abdomen close to the body without constricting the baby.
- B** Carefully fasten the two sides of the body band with the hook and loop strips.

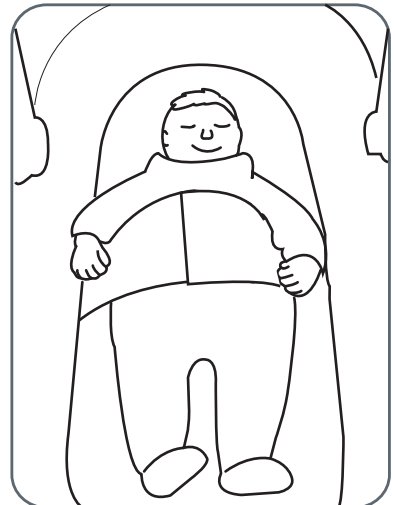



# BASSINET OPERATION

---

## USING THE BODY BAND & D-RING ATTACHMENTS

### IMPORTANT NOTE:

D-RINGS ARE INSTALLED ON THE BASE OF THE BASSINET FOR USE OF AN OPTIONAL BABY HARNESS (SOLD SEPARATELY).

- C If using a harness, the D-Ring will need to be inserted through the button holes in the side of the bassinet liner.

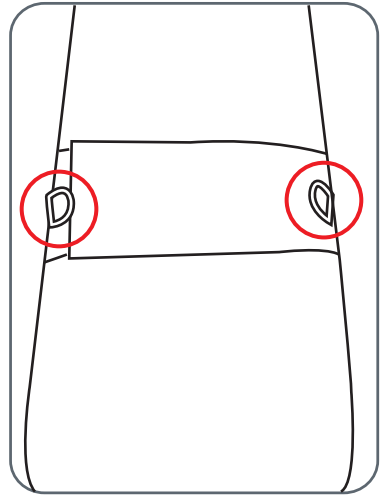

# BASSINET OPERATION

---

## ADJUSTING THE CANOPY



### CAUTION:

**ONLY USE THE CARRY HANDLE WHEN THE CANOPY IS IN THE FULLY EXTENDED AND LOCKED POSITION TO TRANSPORT THE BASSINET.**

- A** Press the hinge buttons on both sides of the carry handle and rotate the handle up or down to the desired position.

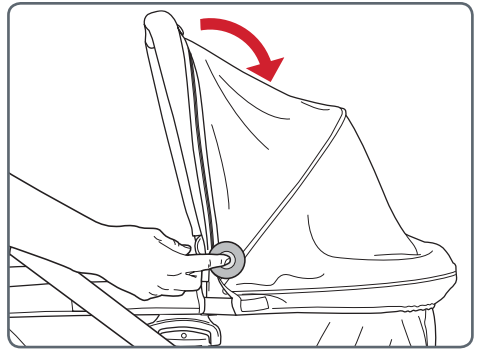

## REMOVING THE BASSINET FROM THE STROLLER FRAME

- A** Engage the stroller brake. (Refer to Page 25)  
Press the bassinet Click & Go release buttons on both sides of the bassinet and lift upwards.

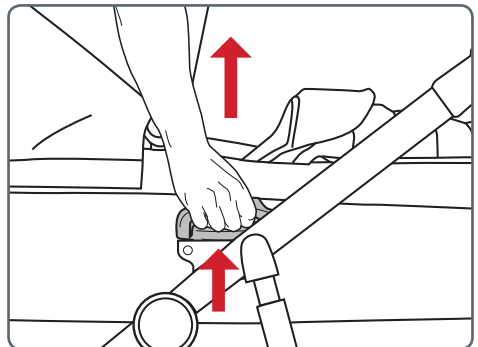

# BASSINET OPERATION

## USING THE BASSINET WITH THE SECOND SEAT

### IMPORTANT NOTE:

EXTENSION ADAPTERS MUST BE USED WHEN USING THE BASSINET WITH THE SECOND SEAT.

- A** Attach the bassinet using the extension adapters by lining up the bassinet Click & Go connectors with the extension adapter receivers and pressing down until the bassinet locks into place.

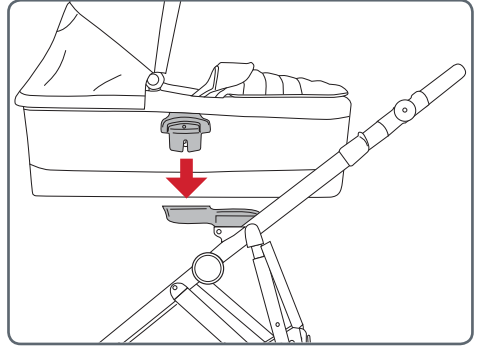

- B** Attach the second seat. (Refer to the Second Seat Section of this Instruction Manual as needed.) For extra room for the child in the second seat, the seat can be placed in a reclined position.

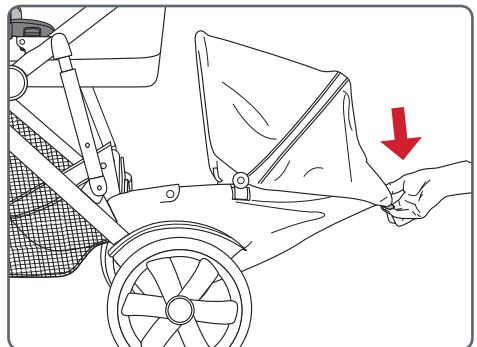
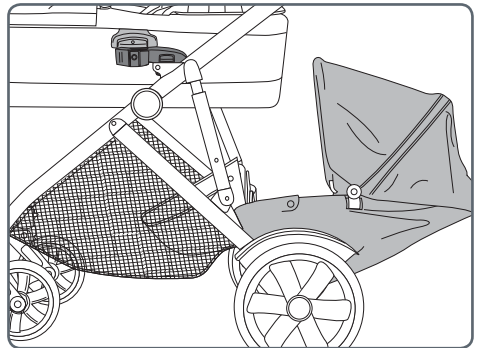

**britax**

**B-READY®  
SECOND SEAT**



# WARNINGS

---

**ALWAYS FOLLOW THE MANUFACTURERS INSTRUCTIONS.  
READ ALL INSTRUCTIONS CAREFULLY BEFORE ASSEMBLY AND USE OF  
THIS STROLLER.  
THE CORRECT USE AND MAINTENANCE OF THIS PRODUCT IS ESSENTIAL.**

## **WARNINGS:**

- **SECURE THE CHILD IN THE HARNESS AT ALL TIMES.**
- **DO NOT USE ANY ACCESSORIES OTHER THAN THOSE APPROVED FOR USE WITH THIS STROLLER BY BRITAX.**
- **IT IS UNSAFE TO USE ACCESSORIES NOT APPROVED FOR USE WITH THIS STROLLER.**
- **THE MAXIMUM WEIGHT OF THE CHILD USING THIS SECOND SEAT IS NOT TO EXCEED 17KG.**

## **IMPORTANT NOTES**

---

- **DO NOT USE THIS SECOND SEAT WITH ANY OTHER MODELS OF STROLLER.**
- **THE SECOND SEAT MUST BE CORRECTLY FITTED AND LOCKED ONTO THE STROLLER FRAME.**
- **THE SECOND SEAT CAN ONLY BE USED IN THE FORWARD FACING POSITION, CONNECTED TO THE REAR OF THE STROLLER.**
- **DO NOT OVERLOAD THE STROLLER. OVERLOADING WILL CAUSE THE STROLLER TO TIP BACKWARDS.**

# PARTS LIST

---

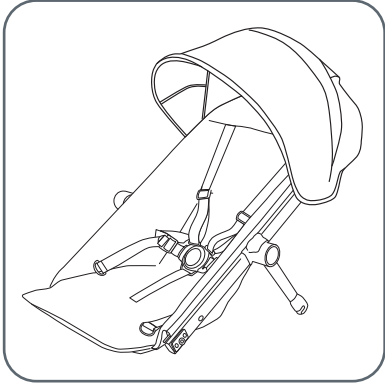

**1 x Second seat**

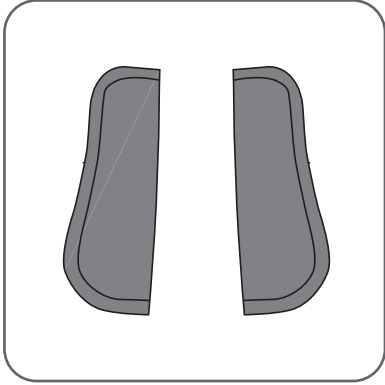

**1 x Set of Shoulder Harness Pads**

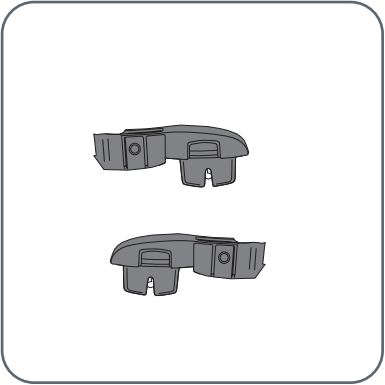

**1 x Set of Extension adapters**

# SECOND SEAT FEATURES

---

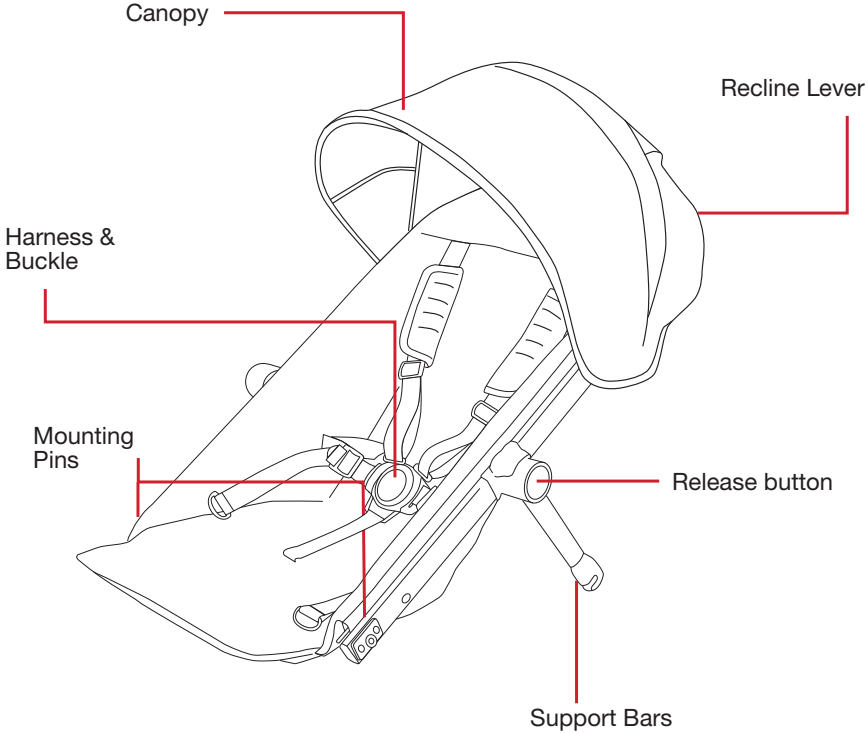

*Actual product may vary from images.*

# SECOND SEAT ASSEMBLY

---

## INSTALLING THE SHOULDER HARNESS PADS

### IMPORTANT NOTE:

ENSURE THAT THE SHOULDER STRAPS ARE FITTED THROUGH THE APPROPRIATE HARNESS SLOTS TO SUIT YOUR CHILD'S SEATED SHOULDER HEIGHT.

- A Release the harness buckles (Refer to Page 32) and slide the shoulder harness pads onto the shoulder harness straps.

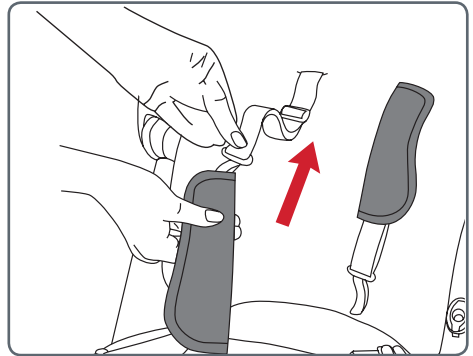



# SECOND SEAT OPERATION

---

## ATTACHING THE SECOND SEAT TO THE STROLLER FRAME

### IMPORTANT NOTES:

PLEASE REFER TO PAGE 7 FOR SMART LIFTING TECHNIQUES.

- WHEN FITTING, OPENING, OR FOLDING THE SECOND SEAT, BE AWARE OF THE DANGER OF BEING INJURED BY MOVING PARTS AND LOCKING DEVICES DURING THE PROCESS. KEEP ALL HANDS AND LIMBS CLEAR OF THESE PARTS.
- THERE IS POTENTIAL FOR FINGERS OR PARTS OF THE BODY TO BE INJURED WHEN THE STROLLER IS BEING FOLDED OR UNFOLDED, DUE CARE SHOULD BE EXERCISED.
- KEEP CHILDREN CLEAR OF THE STROLLER DURING FOLDING OF THE STROLLER.

**PLEASE NOTE:** Extension Adapters can be used to create more space between the stroller seat and second seat.(Refer to Page 70)

- A Engage the stroller brake. (Refer to Page 25)
- B Rotate the pivotal handle to the highest position. (Refer to Page 26)
- C Raise the backrest to the fully upright position. (Refer to Page 60)
- D Slide the hook on each side of the storage basket out of the slots on the stroller frame.

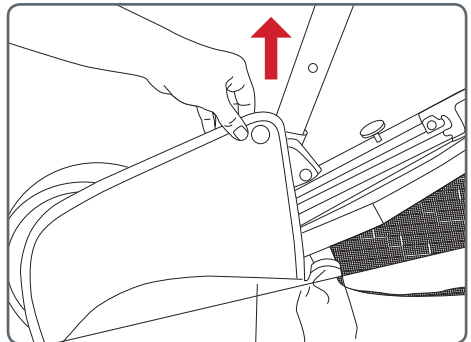

# SECOND SEAT OPERATION

## ATTACHING THE SECOND SEAT TO THE STROLLER FRAME

**E** Push the back of the under-seat storage basket inside out and fold into the storage basket.

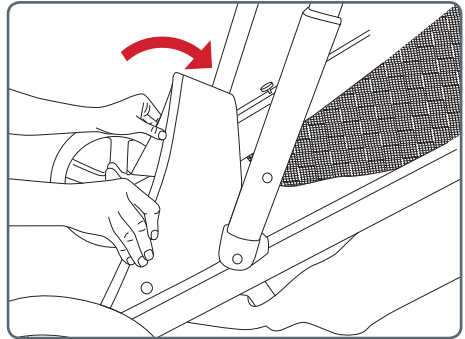

**F** The back of the storage basket can be unzipped and removed instead of folded for more leg room.

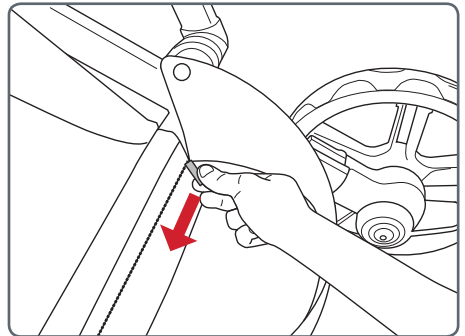

**G** Line up the second seat mounting pins with the mounting brackets on the stroller frame. Line up the support bars on the second seat with the lower mounting brackets on the inside of the stroller frame (located on rear wheel housing).

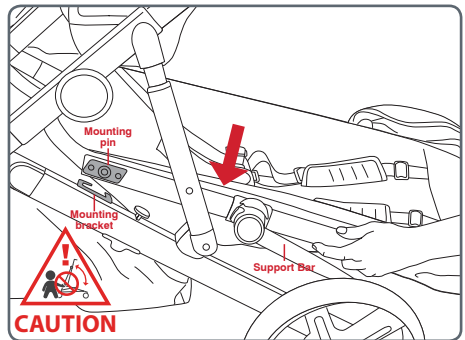

# SECOND SEAT OPERATION

## ATTACHING THE SECOND SEAT TO THE STROLLER FRAME

- H** Slide the mounting pins into the mounting brackets (as indicated by arrow 1) on the stroller frame then pull downwards (as indicated by arrow 2).

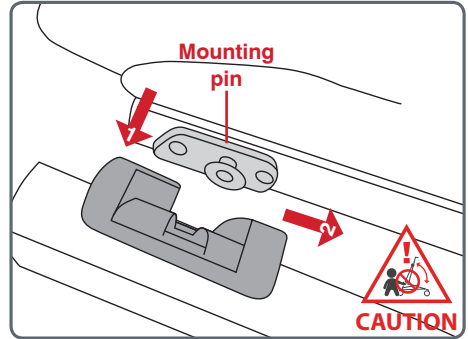

- I** Lower the second seat and press down until the support bars are locked into the lower mounting brackets on the inside of the stroller frame (located on rear wheel housing).

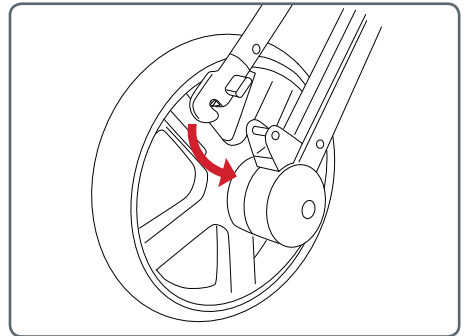

- J** Grasp the sides of the second seat frame and pull upwards to ensure the second seat is locked onto the stroller frame.
- K** Raise the backrest (Refer to Page 60) of the second seat so the foot end slides completely down and engages into the stroller frame.

# SECOND SEAT OPERATION

---

## ADJUSTING THE BACKREST

### **WARNINGS:**

- THE UPRIGHT POSITIONS ARE NOT SUITABLE FOR USE WITH CHILDREN LESS THAN 6 MONTHS OLD.
- THE LOWEST RECLINE POSITION SHOULD BE USED TO TRANSPORT BABIES. THE BACKREST CAN BE ADJUSTED TO A MORE UPRIGHT POSITION AS THE CHILD GROWS OLDER AND IS ABLE TO SUPPORT ITS HEAD WITHOUT ASSISTANCE.

**PLEASE NOTE:** If the child is sitting in the seat, support the backrest as it reclines. If you have difficulty adjusting the backrest you may need to remove the child from the seat to allow you to raise or lower the backrest with ease.

**A** Lift the recline lever at the top of the the seat and hold while raising or lowering the backrest to the desired position.

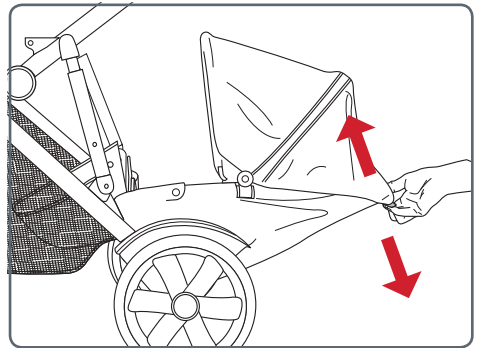

# SECOND SEAT OPERATION

---

## REMOVING THE SECOND SEAT FROM THE STROLLER FRAME

### IMPORTANT NOTES:

PLEASE REFER TO PAGE 7 FOR SMART LIFTING TECHNIQUES.

- ALWAYS REMOVE YOUR CHILD FROM THE SECOND SEAT BEFORE FOLDING OR REMOVING THE SECOND SEAT.

**A** Press the left button on the rear frame and then press and hold the right release button while lifting upward on the seat.

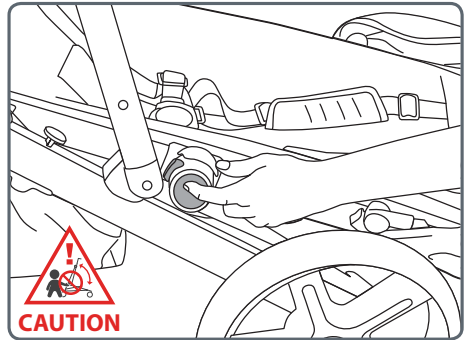

**B** Press the release button on the stroller frame and lift up on the second seat to remove it.

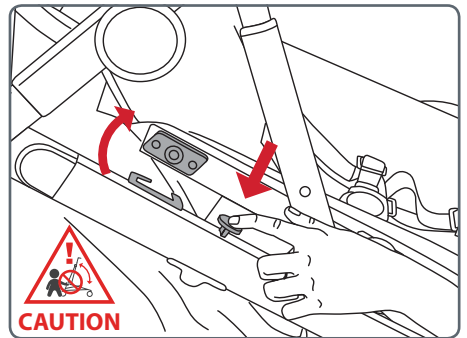

# SECOND SEAT OPERATION

---

## SECURING YOUR CHILD IN THE HARNESS



**WARNING:** USE THE HARNESS AT ALL TIMES.

- ENSURE YOUR CHILD IS SECURED WITH A CORRECTLY ADJUSTED HARNESS.
  - THE ADJUSTED HARNESS SHOULD CLOSELY FIT THE CHILD.
  - NEVER LEAVE THE HARNESS BUCKLED WHEN NOT FITTED TO A CHILD IN THE STROLLER, BECAUSE THE HARNESS CAN FORM LOOPS WHICH MAY POSE A STRANGULATION HAZARD.
  - WHEN HARNESS IS NOT IN USE, DISCONNECT SHOULDER STRAPS FROM THE WAIST STRAPS AND BUCKLE TO PREVENT STRANGULATION.
- 
- A five point harness is provided to restrain your child.
  - Buckle tongues separate for added safety.
  - To reconnect buckle tongues and to secure the child in the harness please follow the steps below carefully.

**PLEASE NOTE:** Each waist buckle tongue has a raised rib on one side and can only be locked into the buckle assembly with the raised rib facing up. Ensure the harness straps are not twisted as they may become uncomfortable for the child.

- A** Always apply the brakes.  
Place child in stroller seat.  
Position the shoulder strap near the child's shoulder.  
Position crotch strap between legs.  
Thread the waist strap buckle tongues through the shoulder straps tongue guides.

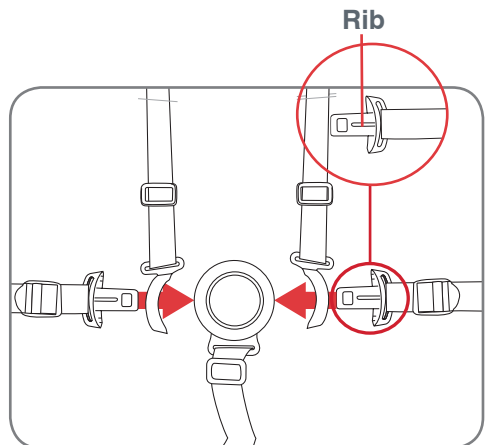

# SECOND SEAT OPERATION

---

## SECURING YOUR CHILD IN THE HARNESS

- B** Hold the centre button in on the crotch buckle and insert the waist buckle tongues into the crotch strap buckle until you hear a 'click'.

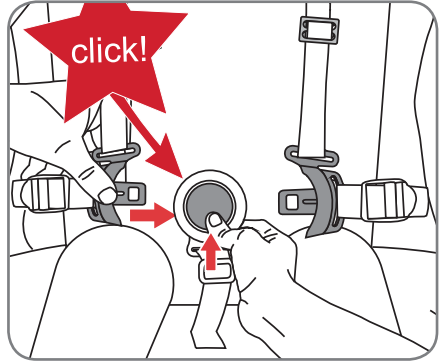

- C** Repeat the procedure on the other side.

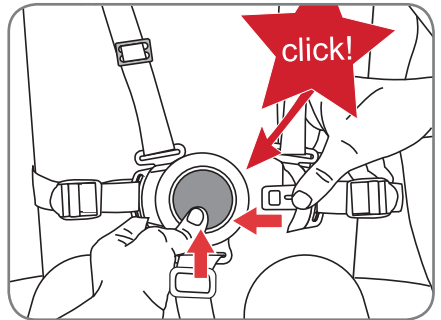

**IMPORTANT:** Pull on each waist buckle tongue to make sure they are locked into the crotch buckle assembly. If not, repeat above procedure.

# SECOND SEAT OPERATION

## ADJUSTING THE HARNESS

**A** Tighten or loosen the shoulder straps and crotch strap by sliding the 3 bar harness adjuster up or down. The crotch strap should be adjusted to a snug fit.

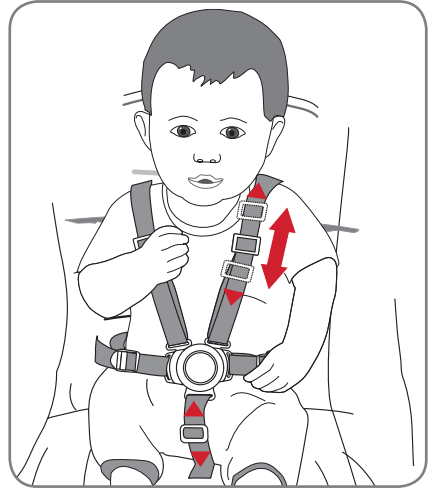

**!** **CAUTION:** DO NOT SLIDE 3 BAR SLIDER OVER THE SEWN TAB ON SHOULDER HARNESS.

**B** Tighten or loosen the waist straps, hold and lift the 4 bar harness adjuster and pull the harness strap to adjust to the desired fit. The waist strap needs to fit firmly around the child.

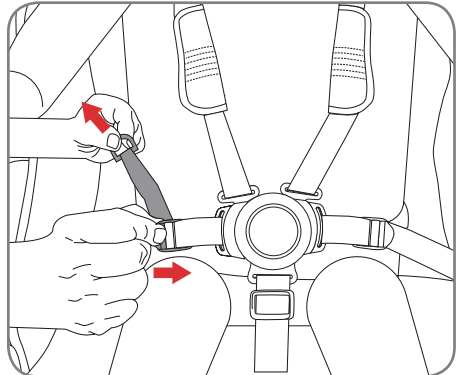



# SECOND SEAT OPERATION

---

## OPENING THE HARNESS

- A Release the harness by pressing the centre button in on the crotch buckle while pulling the waist tongues out of the crotch buckle.

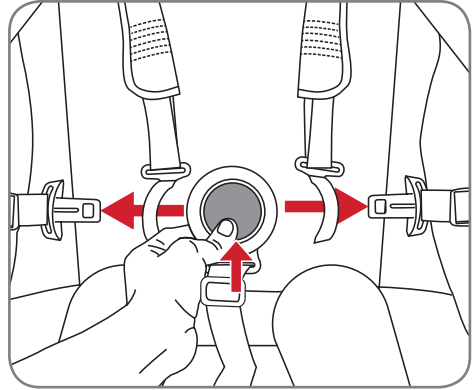

## ADJUSTING THE SHOULDER HARNESS HEIGHT

### IMPORTANT NOTE:

THE HARNESS CAN BE ADJUSTED TO TWO DIFFERENT HEIGHTS TO ACCOMMODATE THE CHILD. THE SHOULDER STRAPS MUST BE POSITIONED NEAR THE CHILD'S SHOULDERS.

- A Push the shoulder harness tongue out of the current harness slot and through the back of the seat pad.

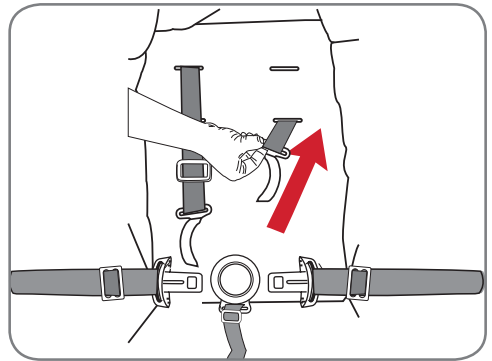

# SECOND SEAT OPERATION

---

## ADJUSTING THE SHOULDER HARNESS HEIGHT

- B** Pull the shoulder harness buckle tongue through the correct harness slot on the seat pad.

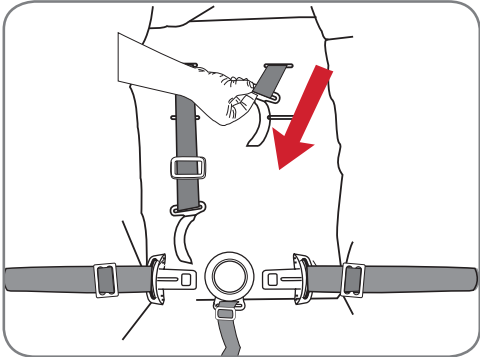

# SECOND SEAT OPERATION

---

## FOLDING THE SECOND SEAT WITH THE STROLLER

### IMPORTANT NOTES:

PLEASE REFER TO PAGE 7 FOR LIFTING TECHNIQUES.

- REMOVE THE CHILD FROM THE SECOND SEAT BEFORE COMMENCING ANY FOLDING OPERATION.
- FOLD THE SECOND SEAT LOWLY AND BE CAREFUL WHERE YOU PLACE YOUR HANDS.
- WHEN FOLDING THE SECOND SEAT BE AWARE OF THE DANGER OF BEING INJURED BY MOVING PARTS AND LOCKING DEVICES DURING THE PROCESS. KEEP ALL HANDS AND LIMBS CLEAR OF THESE PARTS.
- THERE IS POTENTIAL FOR FINGERS OR PARTS OF THE BODY TO BE INJURED WHEN THE SECOND SEAT IS BEING FOLDED, DUE CARE BE EXERCISED.
- KEEP CHILDREN CLEAR OF THE STROLLER DURING FOLDING OF THE STROLLER.

### IMPORTANT NOTE:

INCORRECT FOLDING MAY CAUSE DAMAGE TO THE STROLLER AND FRAME. PLEASE FOLLOW THE FOLDING INSTRUCTIONS CAREFULLY.

- A Remove the child from the second seat.
- B Lock the brakes. (Refer to Page 25)
- C Lock the swivel wheels. (Refer to Page 26)
- D Close the canopy. (Refer to Page 19)
- E Lower the backrest to the lowest recline position. (Refer to Page 60)

# SECOND SEAT OPERATION

---

## FOLDING THE SECOND SEAT WITH THE STROLLER

**F** Adjust the pivotal handle to the highest position. (Refer to Page 26)

**PLEASE NOTE:** You must adjust the stroller handle to the highest position to prevent the handle coming in contact with the second seat and causing damage to the stroller.

**G** Push the seat folding lever and press the second seat until it lies flat.

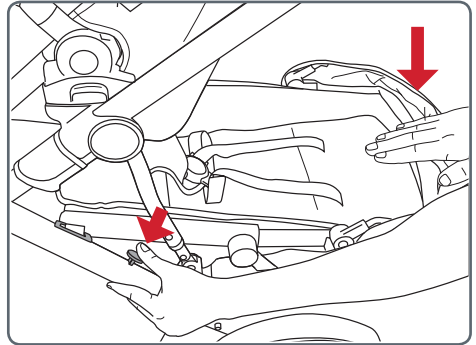

**H** Fold the stroller. (Refer to Page 37)

# SECOND SEAT OPERATION

---

## USING THE SECOND SEAT WITH INFANT CARRIER

### IMPORTANT NOTE:

**EXTENSION ADAPTERS MUST BE USED WHEN USING THE SECOND SEAT WITH THE INFANT CARRIER.**

- A** Attach the extension adapters to the frame by lining up the Click & Go connectors with the Click & Go receivers and pressing down until they lock into place.

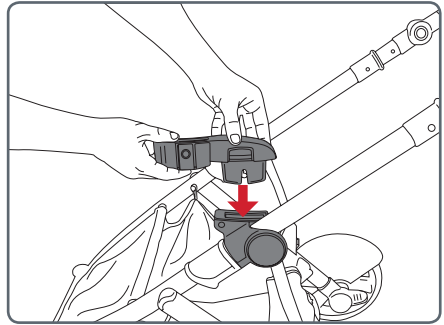

- B** Attach top infant carrier by lining up the Click & Go connectors with the extension adapter receivers and pressing down until they lock into place.

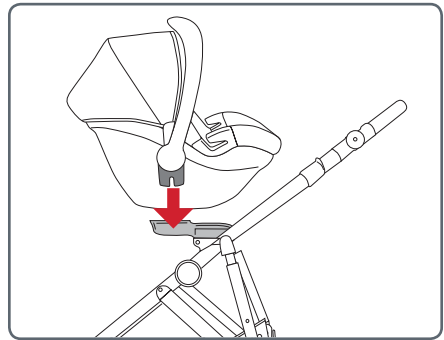

**PLEASE NOTE:** The infant carrier can be used in either the forward facing or rear facing position.

# NOTES

---



**UNITY  
CLICK & GO  
INFANT CARRIER**



# WARNINGS - INFANT CARRIER

---

## WARNINGS:

- IT IS UNSAFE TO USE ACCESSORIES NOT APPROVED FOR USE WITH THIS STROLLER.
- DO NOT USE ANY ACCESSORIES OTHER THAN THOSE APPROVED FOR USE WITH THIS STROLLER BY BRITAX.
- THE MAXIMUM WEIGHT OF THE CHILD USING THE SAFE N SOUND UNITY NEOS INFANT CARRIER OR SAFE N SOUND UNITY INFANT CARRIER ISOFIX COMPATIBLE IS NOT TO EXCEED 12kg.

## IMPORTANT NOTES:

- THE SAFE N SOUND UNITY NEOS INFANT CARRIER OR SAFE N SOUND UNITY INFANT CARRIER ISOFIX COMPATIBLE IS NOT TO EXCEED 12kg ARE THE ONLY COMPATIBLE INFANT CARRIERS DESIGNED TO FIT THE B-READY STROLLER.
- THE INFANT CARRIER MUST BE CORRECTLY FITTED AND LOCKED ONTO THE STROLLER.
- WHEN LOCKED ONTO THE STROLLER FRAME, THE INFANT CARRIER CAN BE USED IN THE FORWARD FACING POSITION WITH THE EXTENSION ADAPTORS SUPPLIED WITH THE SECOND SEAT OR IT CAN BE USED IN THE REARWARD FACING POSITION. (FITTED FACING TOWARD THE STROLLER HANDLE AND FACING THE MOTHER.)
- SECURE THE CHILD USING THE INFANT CARRIER HARNESS AT ALL TIMES
- DO NOT LEAVE CHILD IN THE INFANT CARRIER FOR EXTENDED PERIODS.
- THE INFANT CARRIER IS DESIGNED TO PROVIDE MOBILITY OUTSIDE OF THE CAR BUT IT SHOULD NOT BE USED INSTEAD OF AN APPROPRIATE COT.
- THE INFANT CARRIER MUST BE REMOVED FROM THE FRAME BEFORE FOLDING.



# IMPORTANT NOTES

---

- **THE SUN IS VERY STRONG. DO NOT LEAVE YOUR CHILD EXPOSED TO THE SUN. THE CANOPY OR HOOD ON THIS PRODUCT WILL NOT GIVE YOUR CHILD TOTAL PROTECTION FROM THE HARMFUL RAYS OF THE SUN.**

**BEFORE INSTALLING THE UNITY INFANT CARRIER ON THE STROLLER, THE ARMBAR (SUPPLIED) OR TRAY (SOLD SEPARATELY) MUST BE REMOVED.**

**PLEASE NOTE: THESE INSTRUCTIONS ARE FOR INSTALLING AND REMOVING THE INFANT CARRIER ON THE STROLLER ONLY. FOR INSTALLING AND PROPER USE OF THE INFANT CARRIER IN THE CAR, PLEASE FOLLOW THE INSTRUCTION BOOK PROVIDED WITH THE INFANT CARRIER.**

# INFANT CARRIER

## ATTACHING THE UNITY CLICK & GO INFANT CARRIER TO THE STROLLER FRAME

PLEASE REFER TO PAGE 7 FOR SMART LIFTING TECHNIQUES.

**PLEASE NOTE:** The infant carrier can be used in either the forward facing or rear facing position.

**PLEASE NOTE:** Ensure the baby is secured in the Infant Carrier with the harness at all times. Refer to the Infant Carrier instructions regarding placing and securing your baby in the Infant Carrier.

The Infant Carrier has been fitted with a hood when using the stroller. The hood may also be used in the car.

- A** Engage the stroller brake. (Refer to Page 25)  
Align the Infant Carrier Click & Go connectors with the Click & Go receivers on the stroller frame.

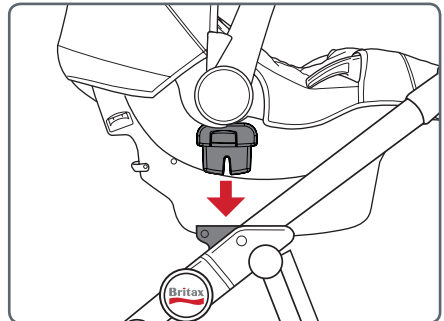

- B** Push down on the infant carrier until a 'click' is heard which indicates the connectors have locked into the receivers.

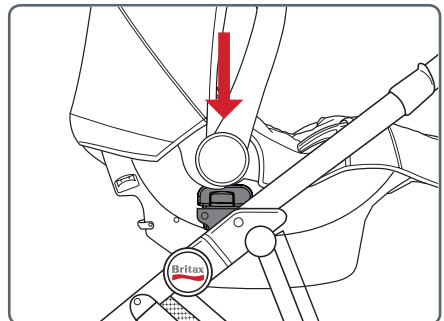

# INFANT CARRIER

---

## ATTACHING THE UNITY CLICK & GO INFANT CARRIER TO THE STROLLER FRAME

- C** Pull up on the infant carrier to ensure that it is securely locked onto the stroller frame.

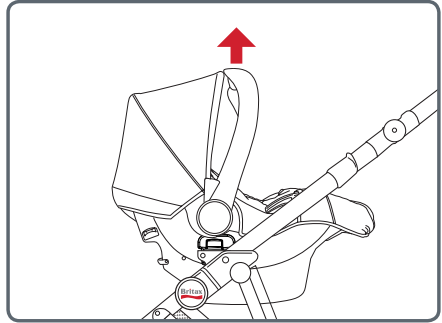

## REMOVING THE UNITY CLICK & GO INFANT CARRIER TO THE STROLLER FRAME

**PLEASE REFER TO PAGE 7 FOR SMART LIFTING TECHNIQUES.**

- A** Engage the stroller brake. (Refer to Page 25)  
Squeeze both release levers on the Click & Go connectors at the same time and support the weight of the infant carrier.

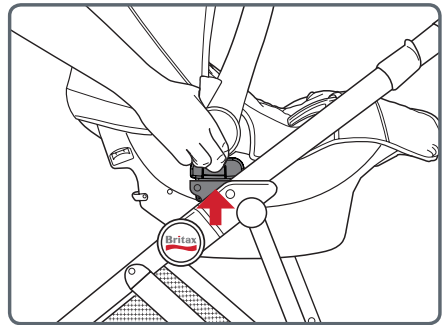

# INFANT CARRIER

---

## REMOVING THE UNITY CLICK & GO INFANT CARRIER TO THE STROLLER FRAME

**B** Lift the remove the Infant Carrier from the stroller frame.

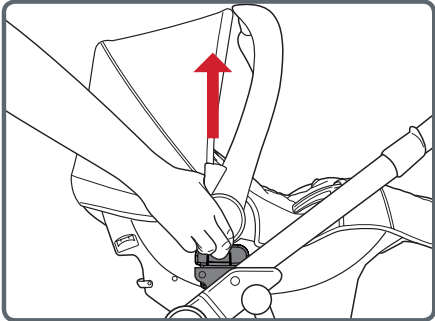

# CARE AND MAINTENANCE

---

- To prolong the life of your stroller keep it clean and do not leave it in the direct sunlight or in the car boot for extended periods of time.
- Removable fabric covers and trims may be cleaned using warm water with a household soap or mild detergent. Allow it to dry fully, preferably away from the direct sunlight.
- Non removable fabric covers and trims may be spot cleaned using a damp sponge with soap or a mild detergent. Allow it to dry completely before folding or storing it away.
- In some climates the covers and trims may be affected by mould and mildew. To help prevent this occurring, do not fold or store the product if it is damp or wet. Always store the product in a well ventilated area.
- When using your stroller at the beach - completely clean your stroller afterwards to remove the sand and salt from the mechanisms and wheel assembly. Sand and salt will cause premature wear and corrosion.
- If there are compression marks on the tyres - Use a domestic hair dryer to gently warm (DO NOT OVERHEAT) the tyre and the compression marks should slowly disappear.
- Always check parts regularly for tightness of screws, nuts, and other fasteners - tighten if required. To maintain the safety of your nursery product, seek prompt repairs for bent, torn, worn or broken parts.

**THIS PRODUCT IS NOT INTENDED FOR COMMERCIAL USE.**

# NOTES

---

# NOTES

---

[youtube.com/britaxaustralia](https://www.youtube.com/britaxaustralia)



[facebook.com/britaxaustralia](https://www.facebook.com/britaxaustralia)



[twitter.com/britaxaustralia](https://twitter.com/britaxaustralia)



[pinterest/britaxaustralia](https://www.pinterest.com/britaxaustralia)



[britax.com.au](http://britax.com.au)



1300 303 330



BRITAX CHILDCARE PTY. LTD.  
A Britax International Company  
ABN 55 006 773 6000  
99 Derby Road Sunshine  
Victoria 3020 Australia  
Britax Childcare Pty Ltd  
(Customer Service 1300 303 330)  
Britax Childcare (NZ) Ltd  
(Customer Service 0508 688 822)

Due to the variations in style and design of our products, the illustrations used in this instruction booklet are generic. We reserve the right to alter these products without notice. The Britax Trademark is the property of Britax Childcare Holdings Limited - UK.

This product is designed to comply with Australian and New Zealand standard AS/NZS2088:2013 "Prms and Strollers - Safety Requirements."

©2016 Copyright Britax Childcare Pty. Ltd. Australia